



## 20<sup>th</sup> Century Train Station

Please read the instructions before starting construction.

When opening the kit you will notice the smell of burned wood. This is because the parts are laser-cut, which literally means a very tight light beam burns through the material. You may also notice some soot at the cut edges. The amount of soot depends on the material used. You can considerably reduce it by gently wiping at least the bigger and easy to reach edges with a soft cloth or household tissue.

PVA or equivalent glue will be required to glue parts together. Give glue enough time to dry. Wipe away any excess glue immediately using a fine cloth or the tip of a toothpick. A sharp hobby knife is needed to remove parts from the sheet. Be careful and always cut away from your body. Fine sand paper may be useful to clean these areas or any tight fitting joints. Clamps, pegs and elastic bands may help during the construction of the kit. Make sure that the parts are aligned correctly before applying any of these tools.

### General pre-assembly preparations

You will achieve the best results in finishing this kit when you follow the steps listed below. Always double check with the provided pictures before gluing parts together and moving on to the next step.

Please keep in mind that - in general - engraved sides of parts are considered “outside”; not engraved sides are “inside” or positioned less visible once the kit is finished.

For easier construction this instruction is split into different sections as seen in the layout below:



**It is highly recommended to complete only one section at a time!**

### Preparation of walls:

Start by gluing windows and doors on the inside of the walls. You may cut out the doors to glue them in at an opened position at a later stage of the build.

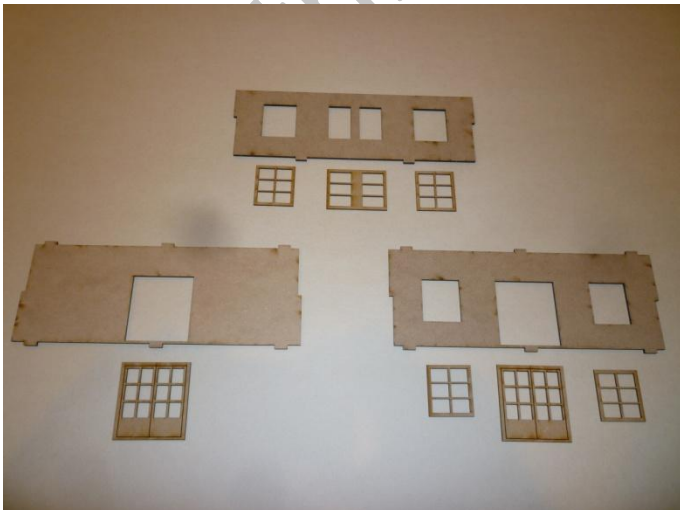

# Master Builder Series



Things from the Basement, LLC  
Dollhouse & Wargaming Miniatures

## Main Hall:

Glue the four walls in place as shown. Double check the alignment of the floor piece! Glue support on top.



Prepare ticket offices by gluing frames, handle and window board on the outside.

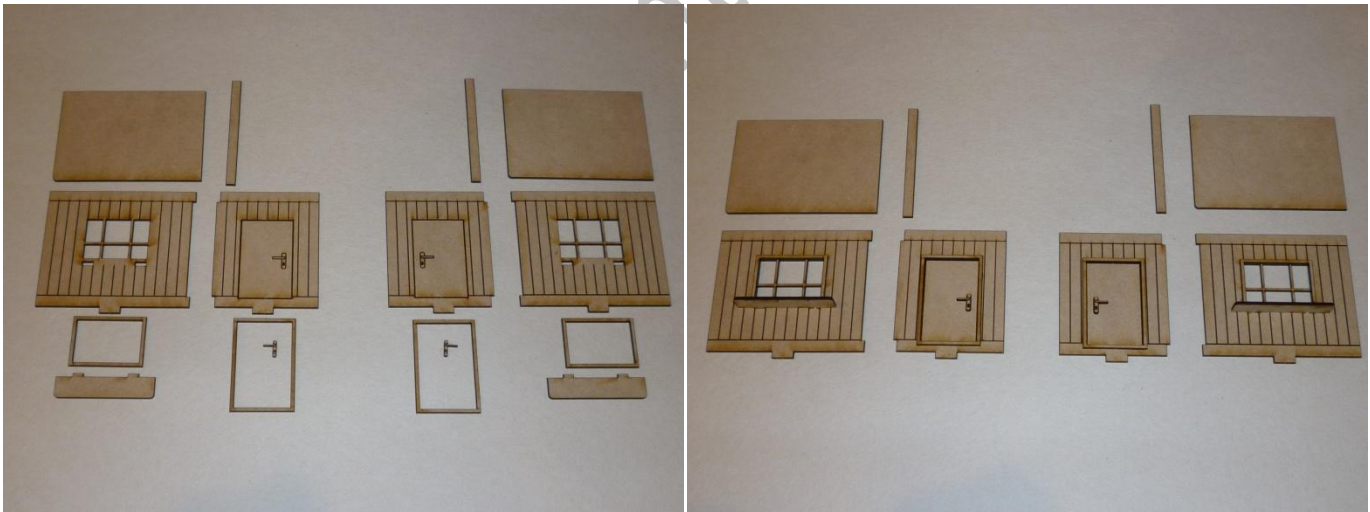

# Master Builder Series



Things from the Basement, LLC  
Dollhouse & Wargaming Miniatures

Glue the ticket offices in place. The roof rests on the walls and the support beam in the corner – no glue required.



Glue the decor elements on the walls as shown.

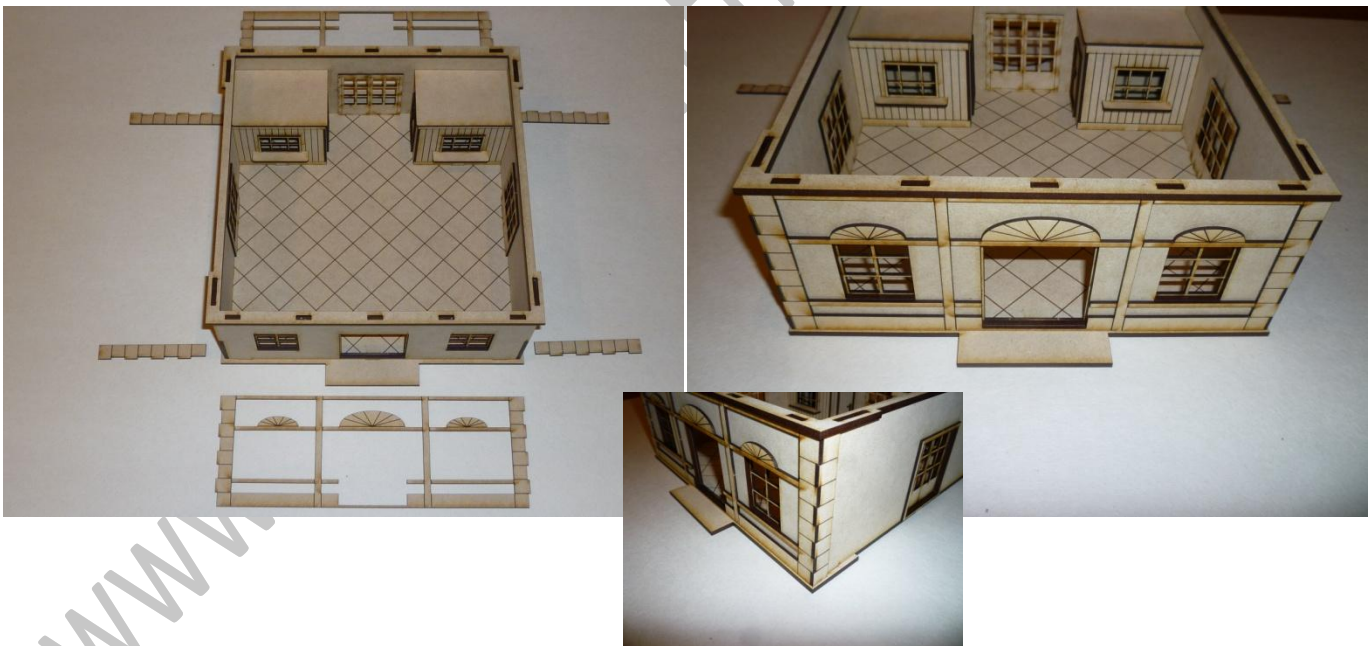



# Master Builder Series



Things from the Basement, LLC  
Dollhouse & Wargaming Miniatures

Glue the four second floor walls in place as shown. Then add the décor elements.

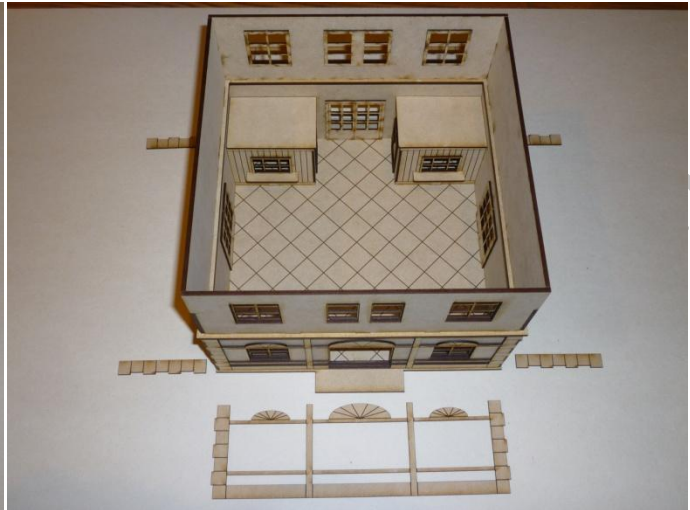
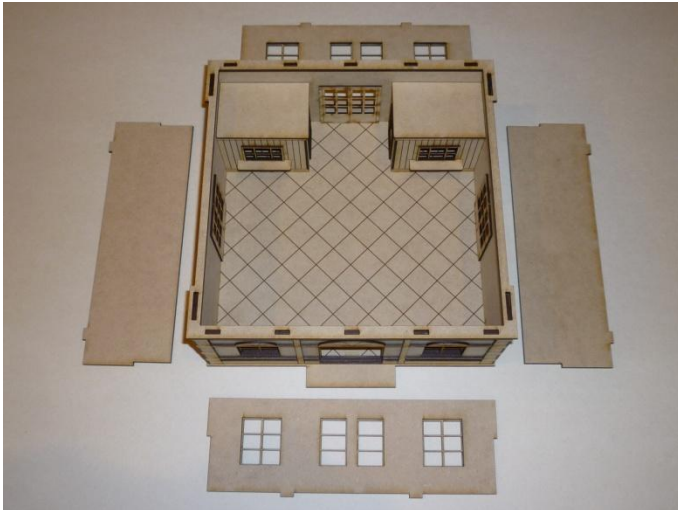

Glue the four roof support in place as shown.

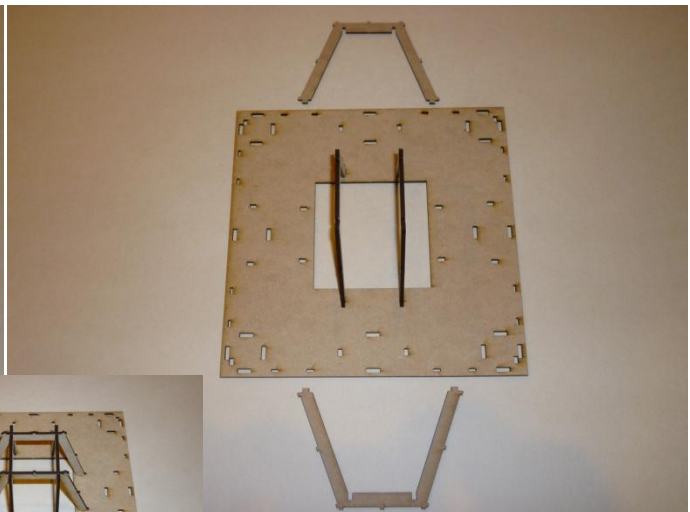
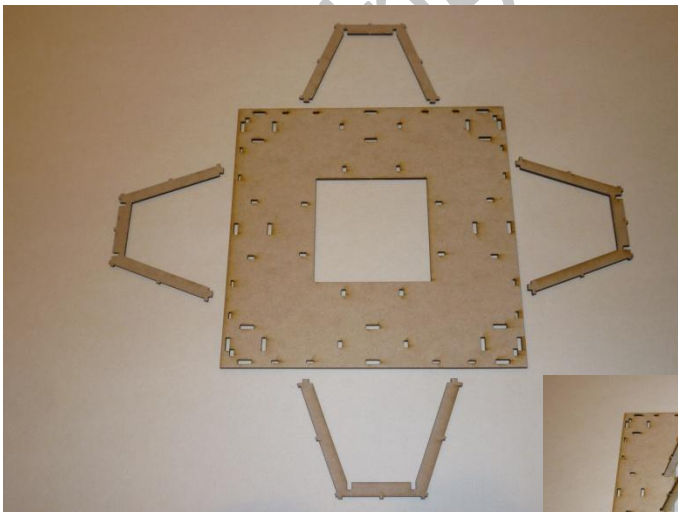

# Master Builder Series



Things from the Basement, LLC  
Dollhouse & Wargaming Miniatures

Add the four roof panels and the square piece as shown.

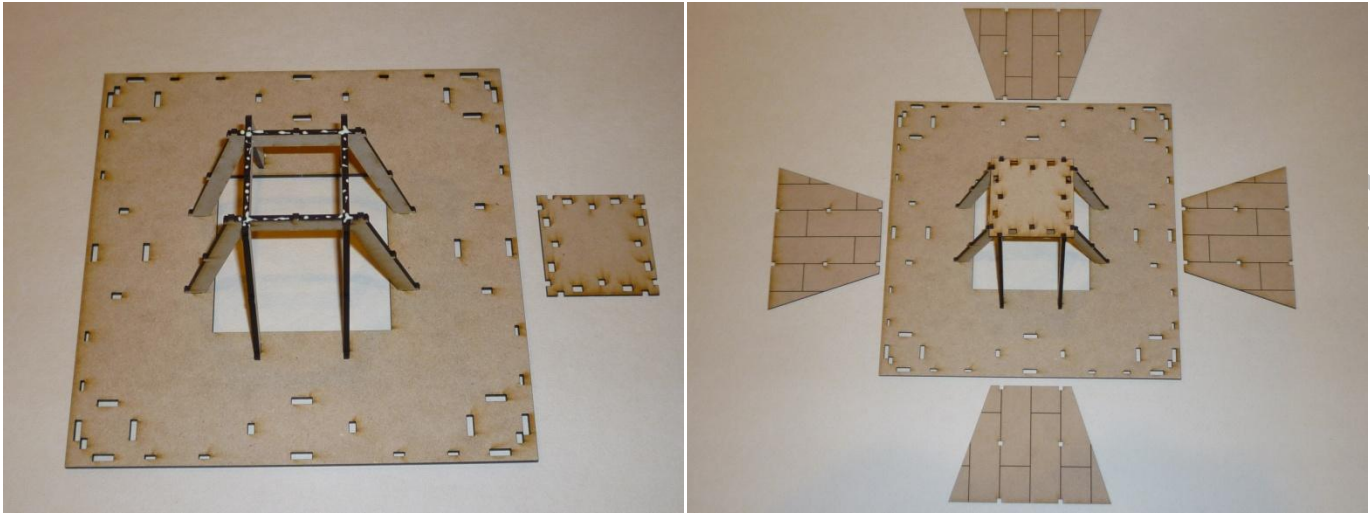

Continue by adding the roof top as shown. Finish by gluing the flagpole in position.

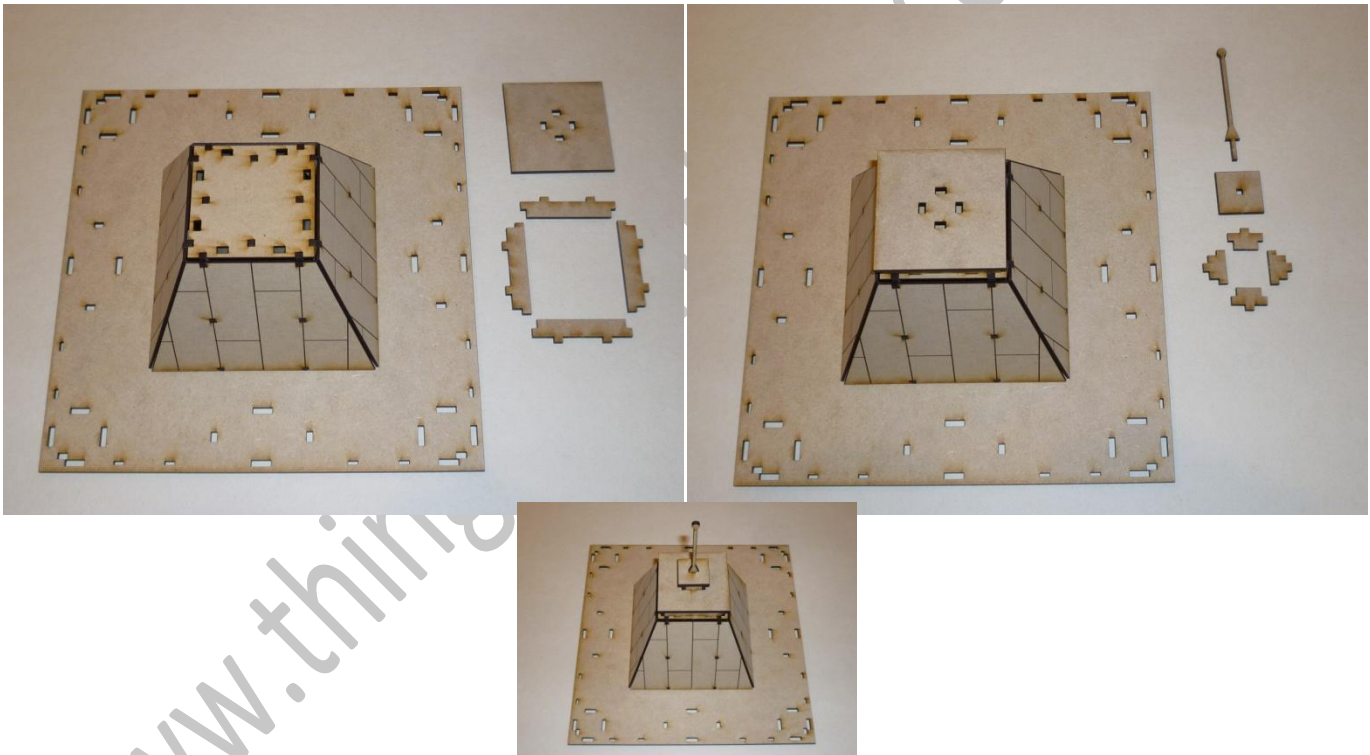



# Master Builder Series



Things from the Basement, LLC  
Dollhouse & Wargaming Miniatures

Build the big decor element as shown. Repeat for every side of the roof.

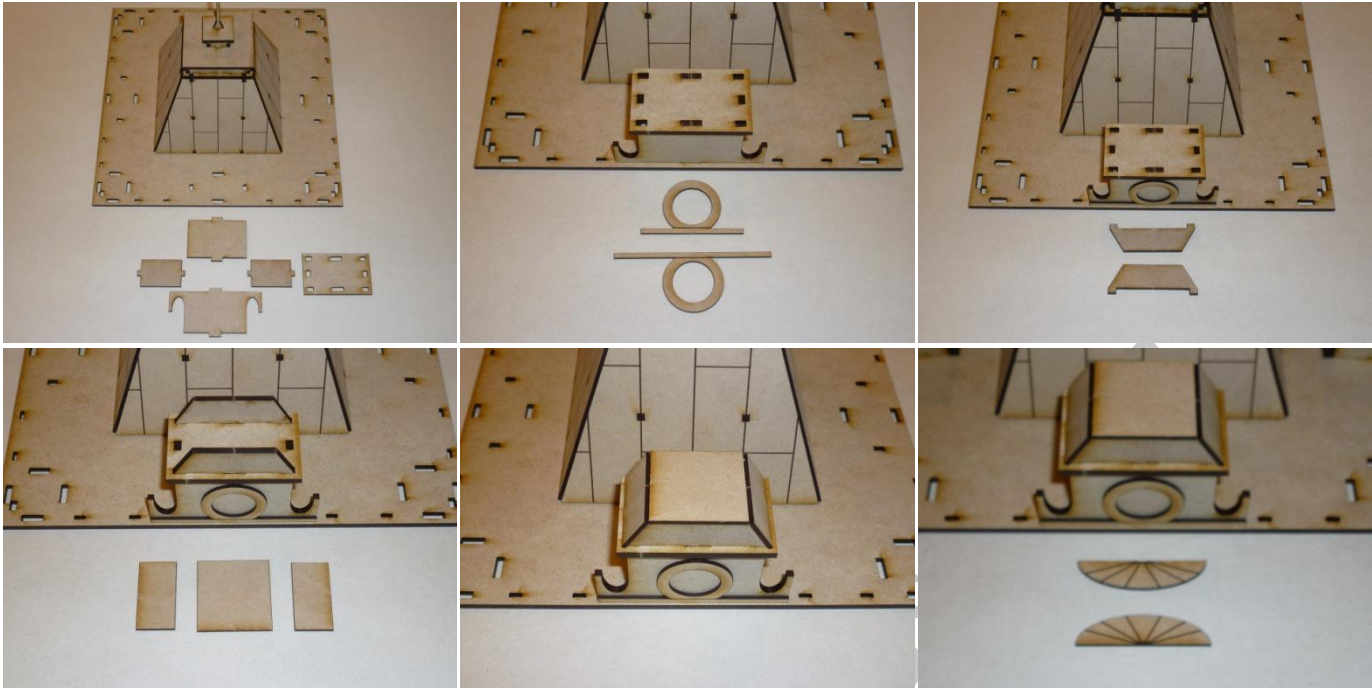

Now add the small decor element at each corner of the roof.



Finally add eight railing pieces.

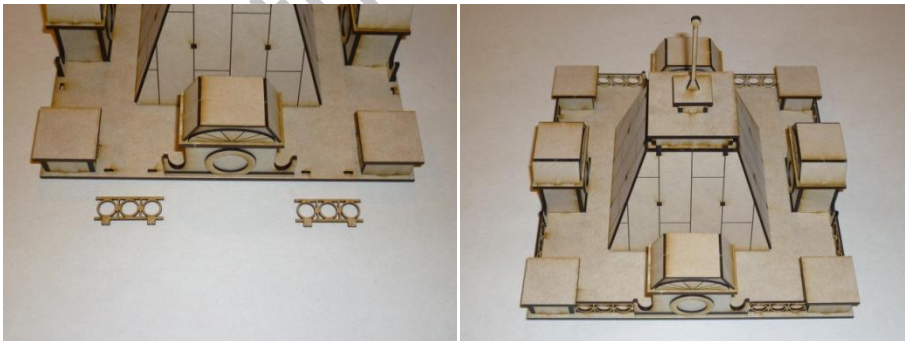

# Master Builder Series



Things from the Basement, LLC  
Dollhouse & Wargaming Miniatures

Turn roof piece upside down and glue four pegs in place. This will keep the roof piece in place and allow lifting it up to reach the interior.

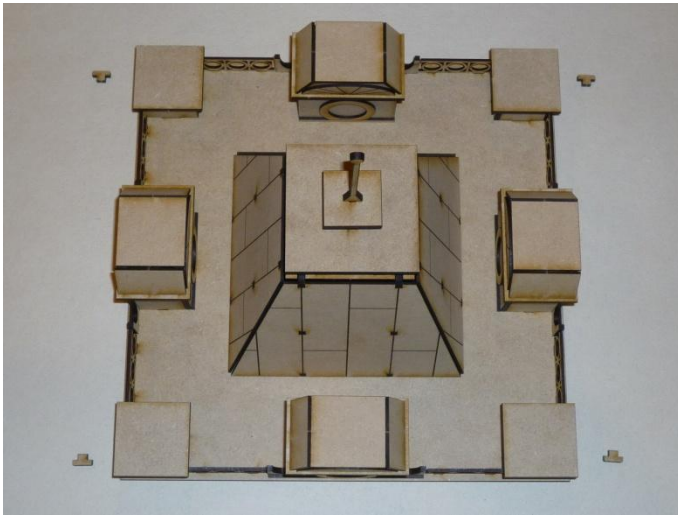

## Tower 1:

### *1<sup>st</sup> floor*

Glue the four walls in place as shown. Double check the alignment of the floor piece!

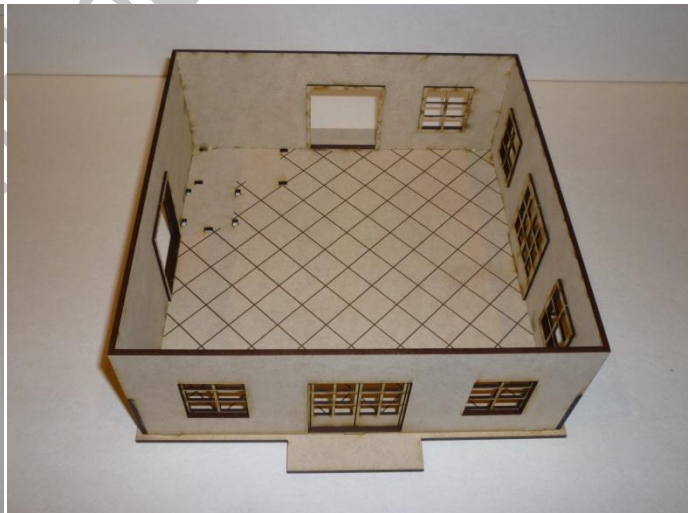
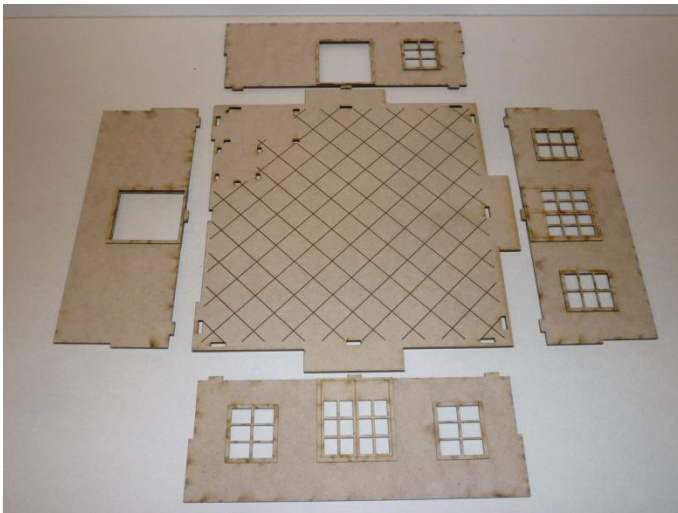



# Master Builder Series



Things from the Basement, LLC  
Dollhouse & Wargaming Miniatures

## Stairs:

Put the two side walls of the lower part of the stairs on the base as shown. **Do not glue them yet!** Now glue the two treads with the opening for the railing and the corner piece in place as shown. Then add the regular treads in place. **Let dry thoroughly!**

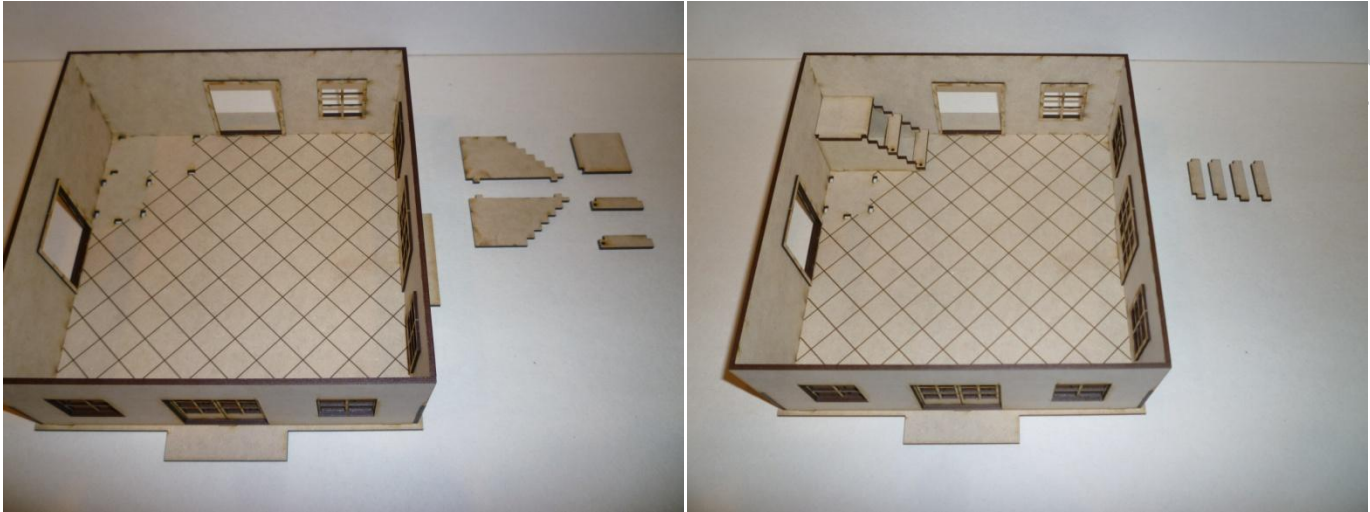

Take out the stair construction and turn upside down. Glue raisers in place as shown.

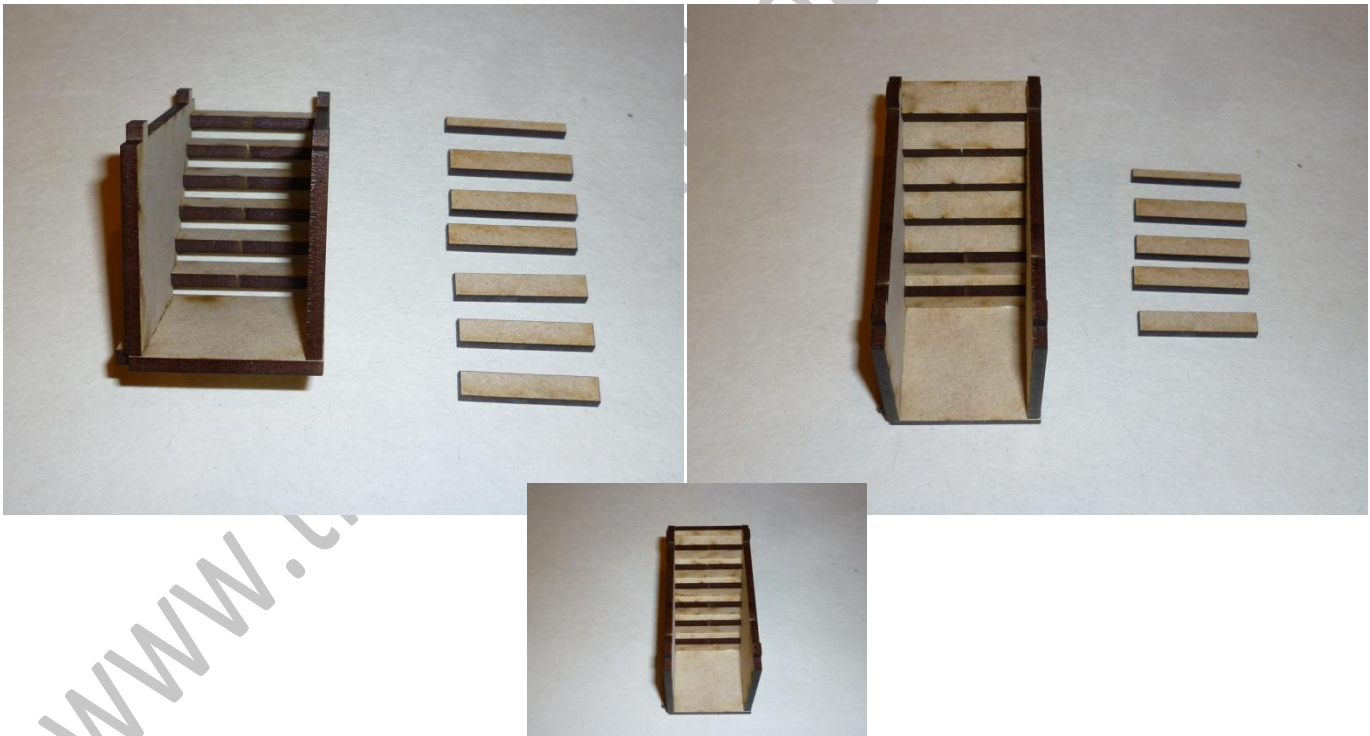





# Master Builder Series

Repeat all steps for the upper part of the stairs.

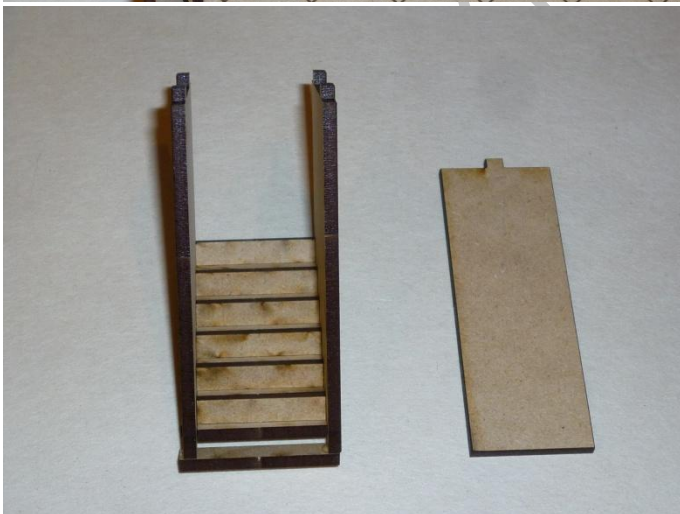
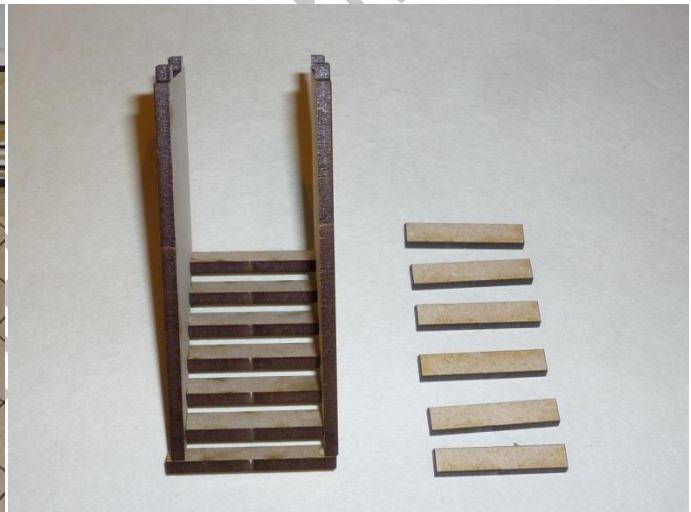
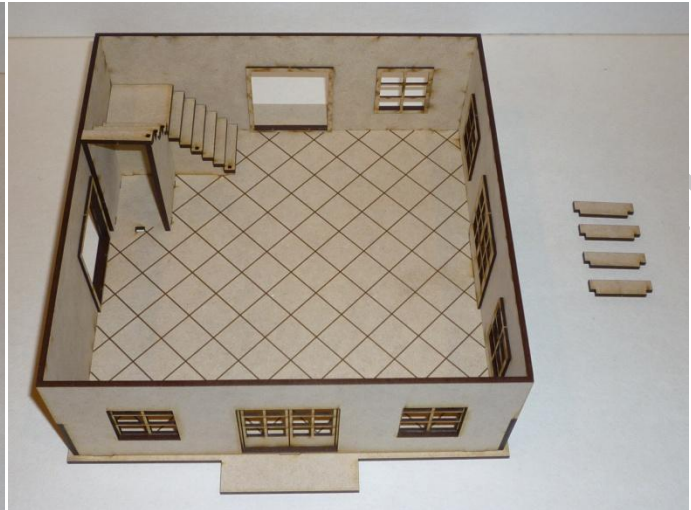
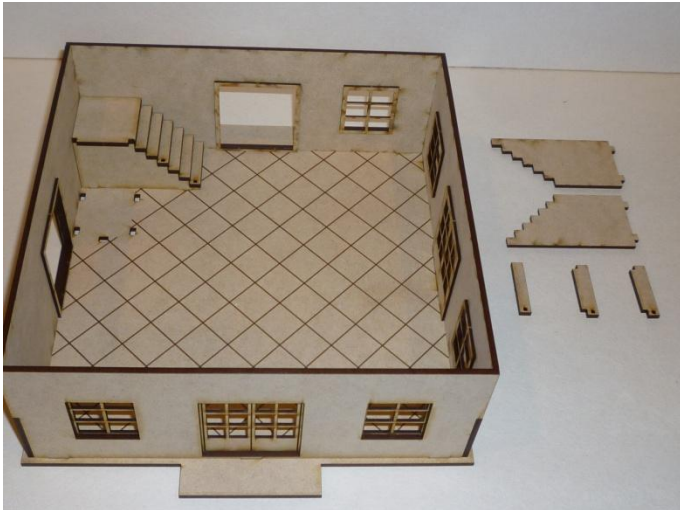

# Master Builder Series



Things from the Basement, LLC  
Dollhouse & Wargaming Miniatures

Once dried, glue lower and upper stairs onto base.

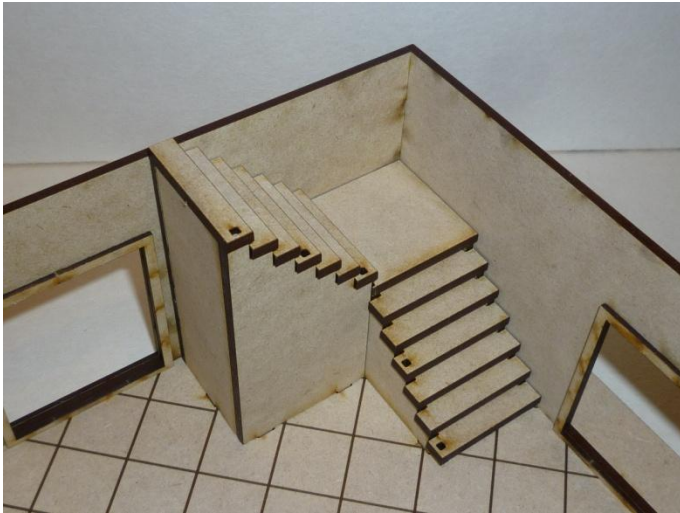

Glue the decor elements on the walls as shown.

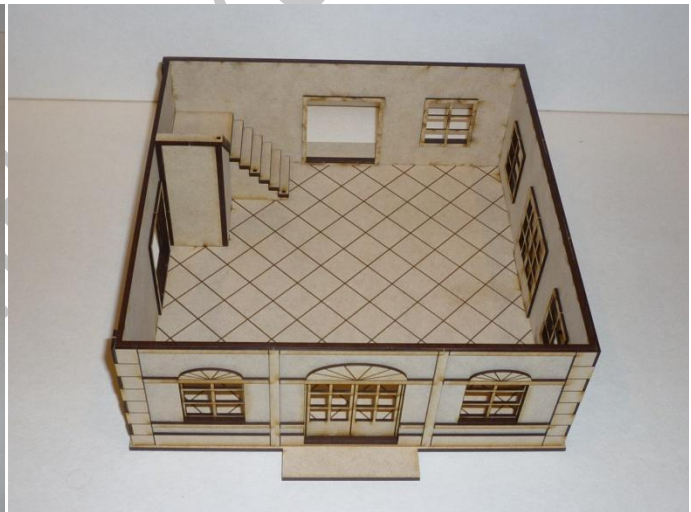
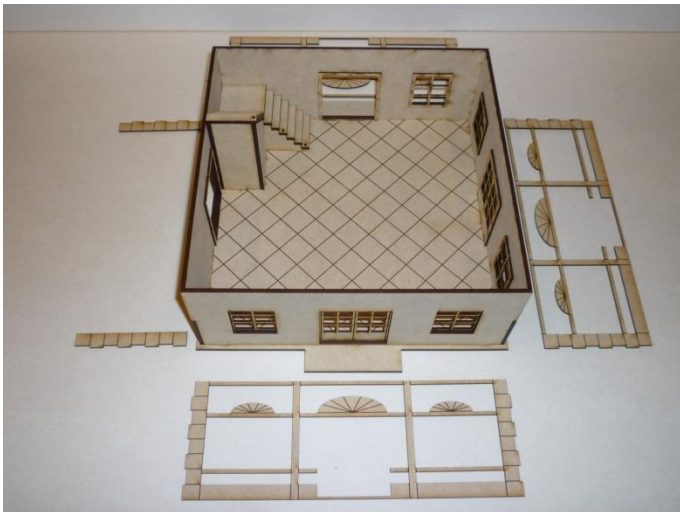

## 2<sup>nd</sup> floor

Glue the four walls in place as shown. Double check the alignment of the floor piece!

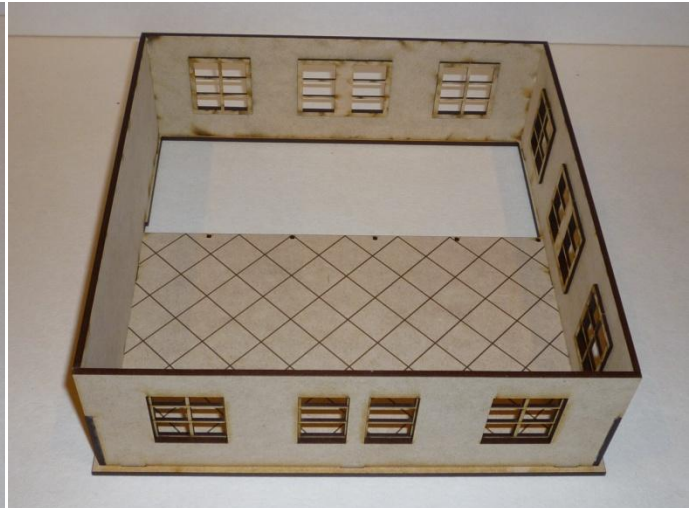
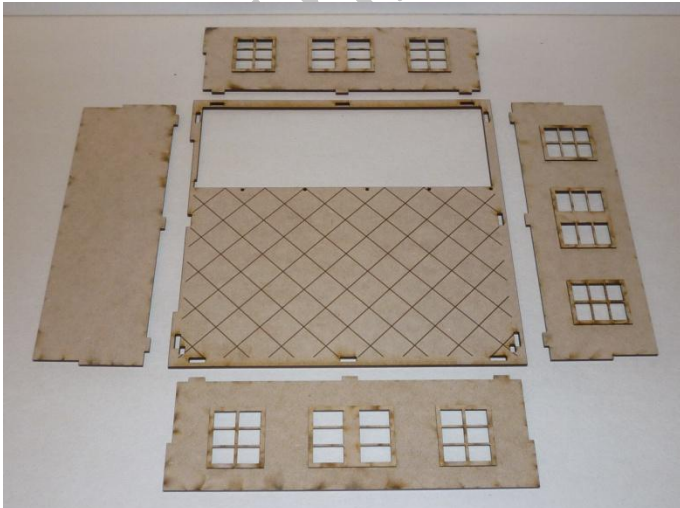



# Master Builder Series



Things from the Basement, LLC  
Dollhouse & Wargaming Miniatures

Glue the decor elements on the walls as shown.

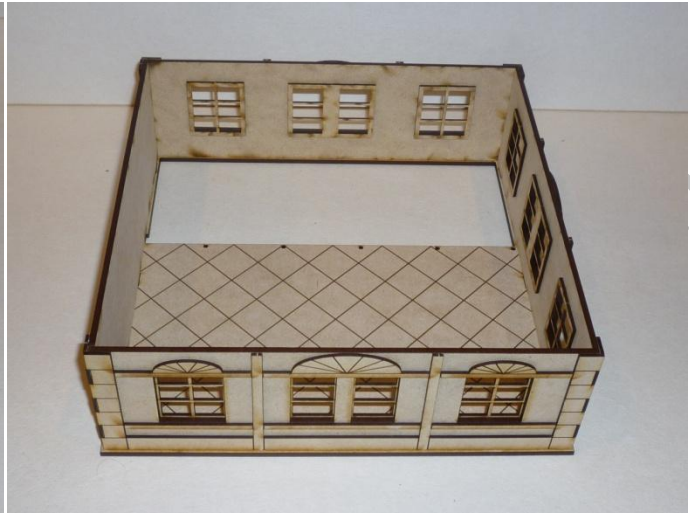
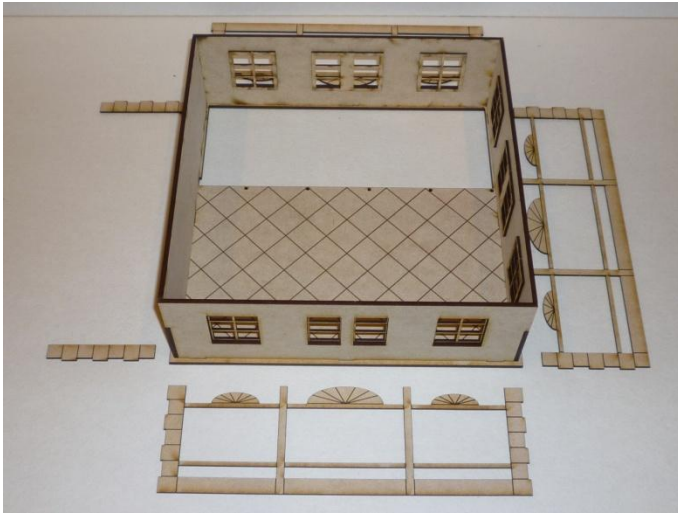

Turn 2<sup>nd</sup> floor piece upside down and glue three pegs in place. This will keep the 2<sup>nd</sup> floor piece in place and allow lifting it up to reach the interior.

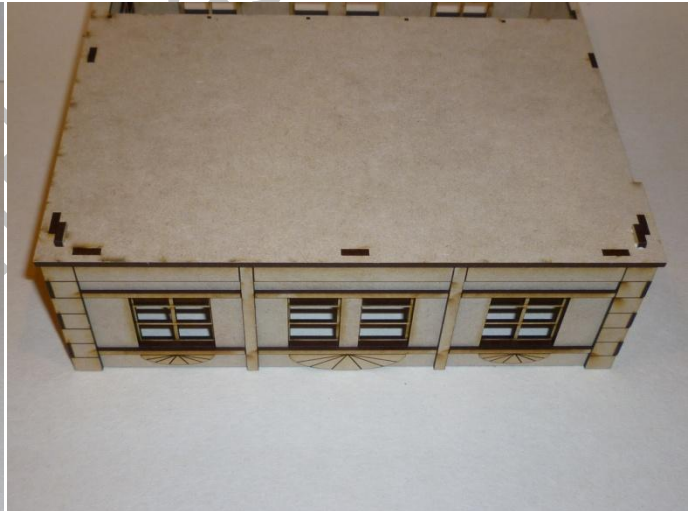
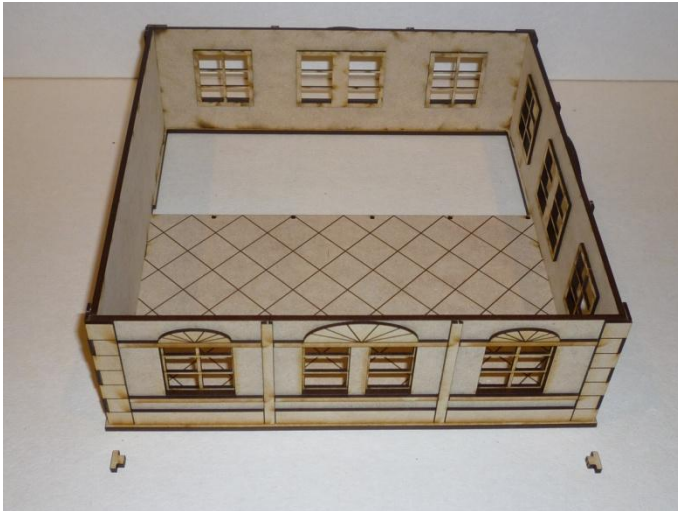

# Master Builder Series



Things from the Basement, LLC  
Dollhouse & Wargaming Miniatures

Glue the railings in place. Glue doors in place as desired when chosen this option.



## ***Roof***

Repeat roof construction from Main Hall. **Make sure roof alignment is identical to 1<sup>st</sup> floor and 2<sup>nd</sup> floor alignment!**

## **Tower 2:**

Repeat all steps as described for Tower 1. Just keep in mind that this tower is a mirrored version of Tower 1!

## **Hallway 1:**

Glue two vertical supports on both wall pieces.

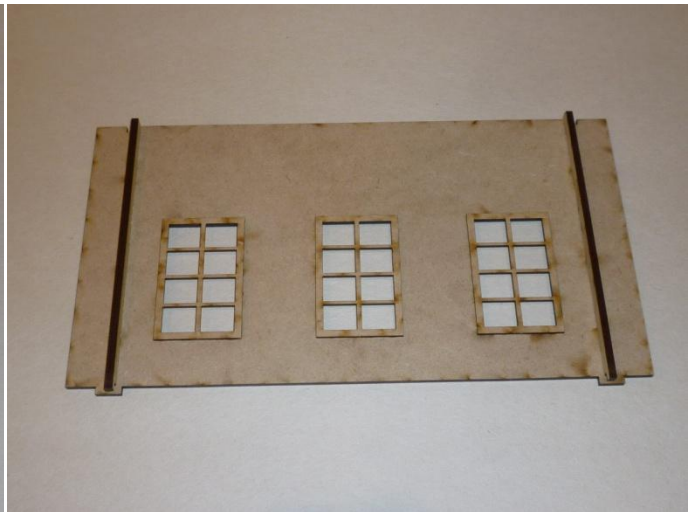
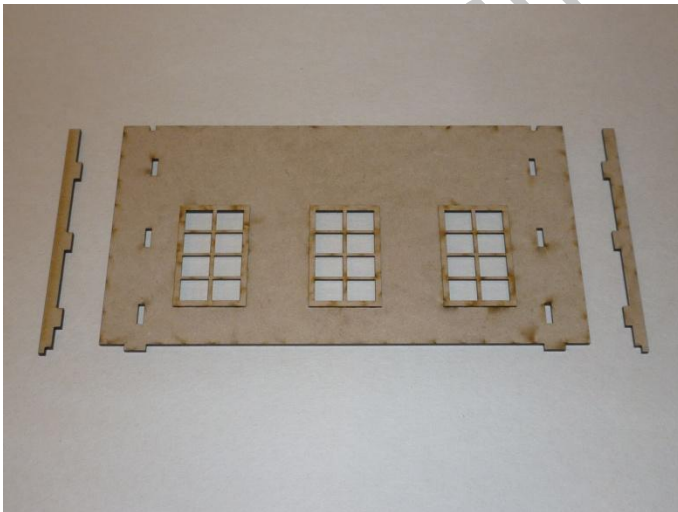



# Master Builder Series



Things from the Basement, LLC  
Dollhouse & Wargaming Miniatures

Glue walls onto base. Add horizontal support beams.

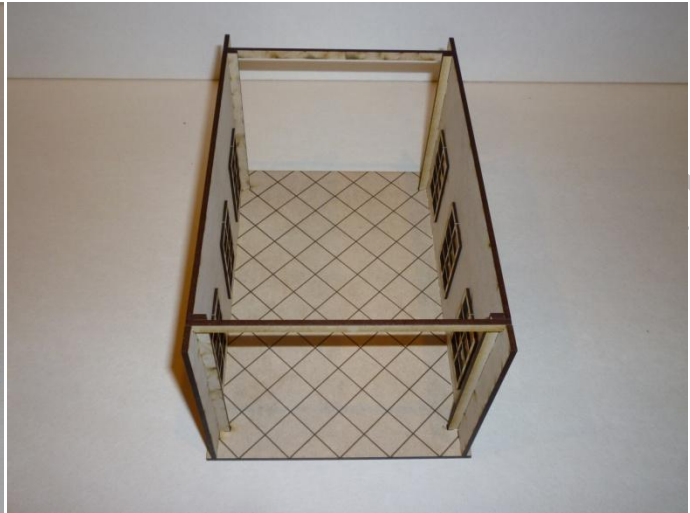
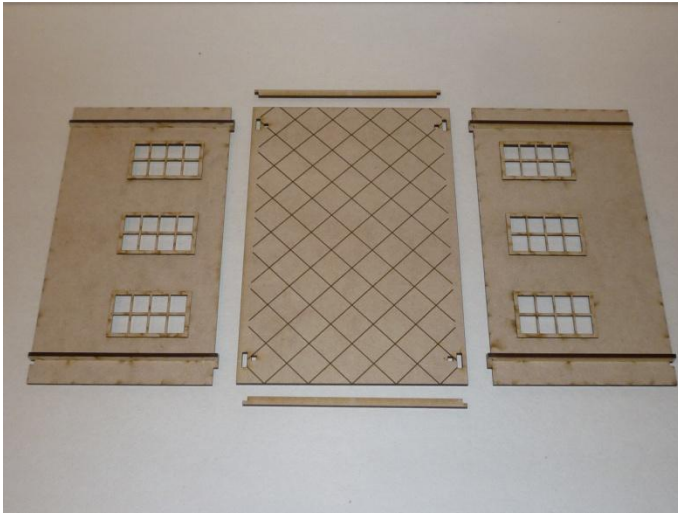

Glue the decor elements on the walls.

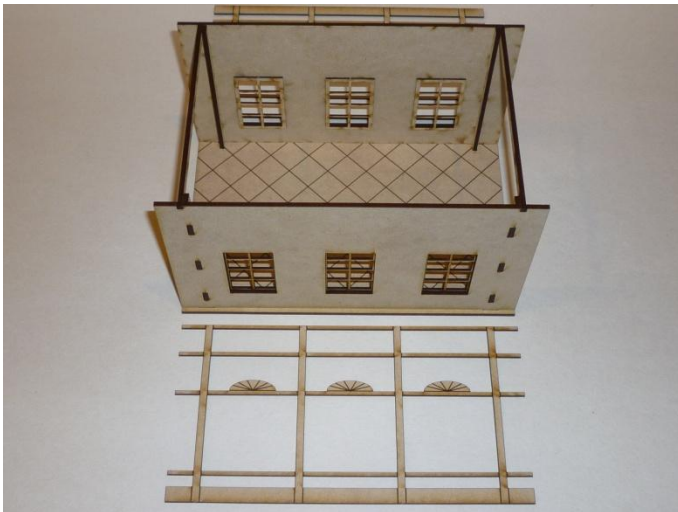

## **Roof**

Glue three triangle-shaped supports in place. Add horizontal support beam.

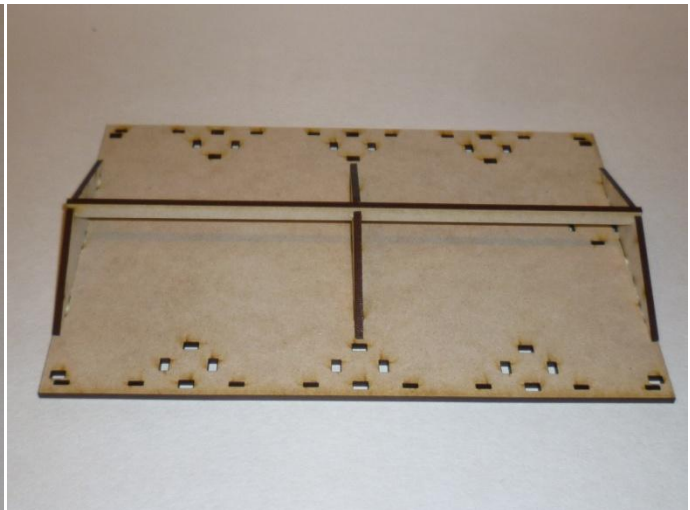
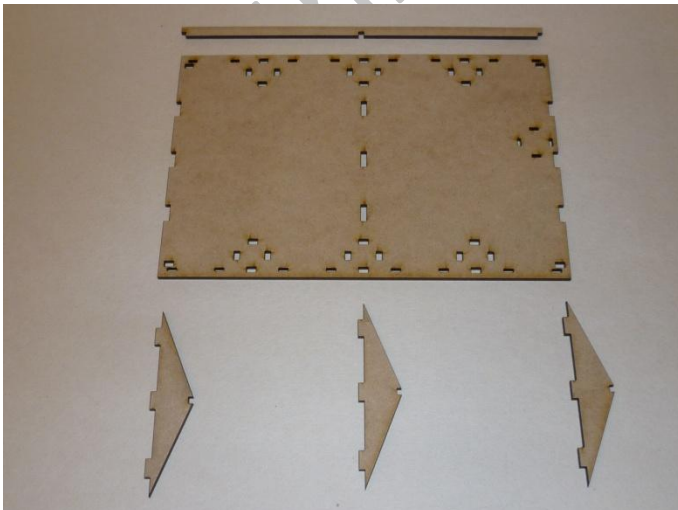

# Master Builder Series



Things from the Basement, LLC  
Dollhouse & Wargaming Miniatures

Add three small decor elements at each side of the roof.

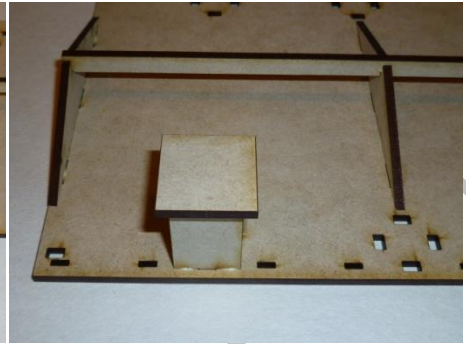
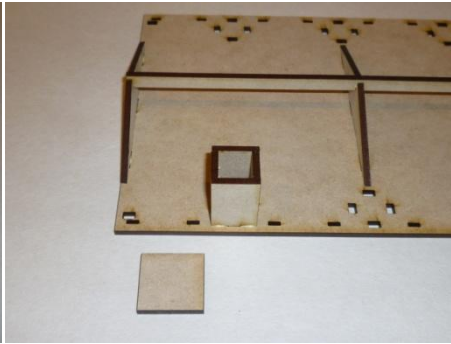
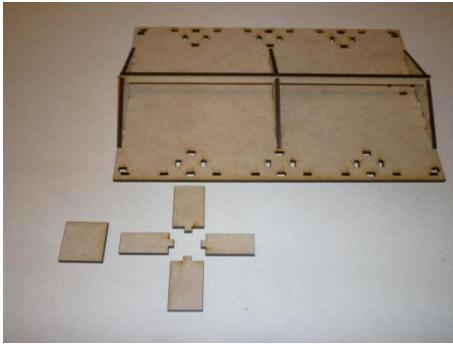

Finally add eight railing pieces.

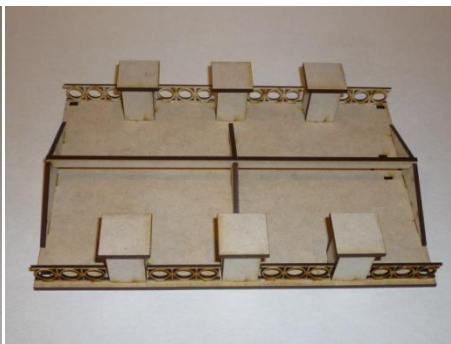
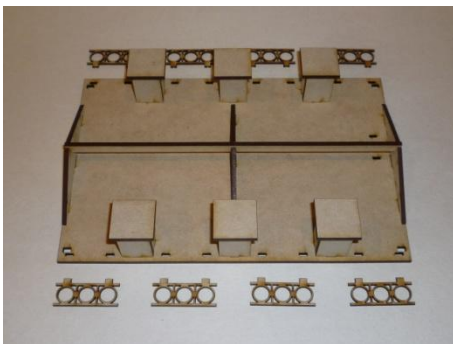

Build chimney as shown.

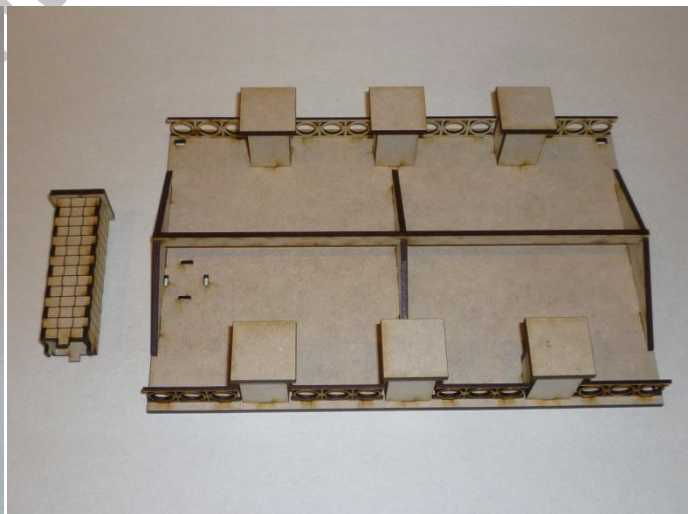
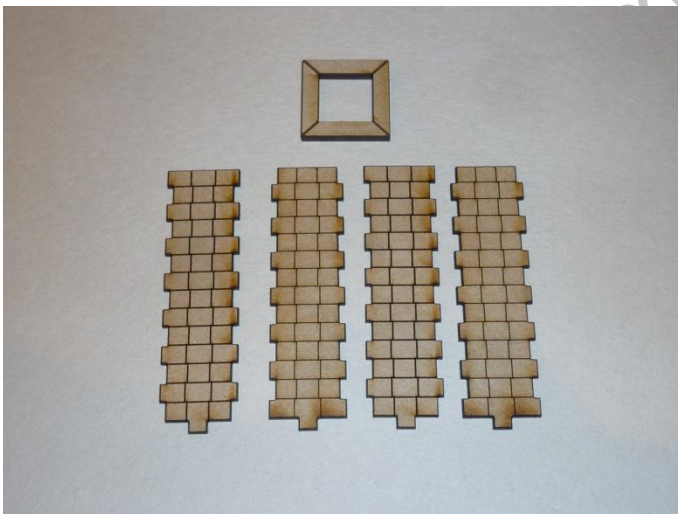



# Master Builder Series



Things from the Basement, LLC  
Dollhouse & Wargaming Miniatures

Glue chimney in place and add roof panels. Turn roof piece upside down and glue four pegs in place. This will keep the roof piece in place and allow lifting it up to reach the interior.

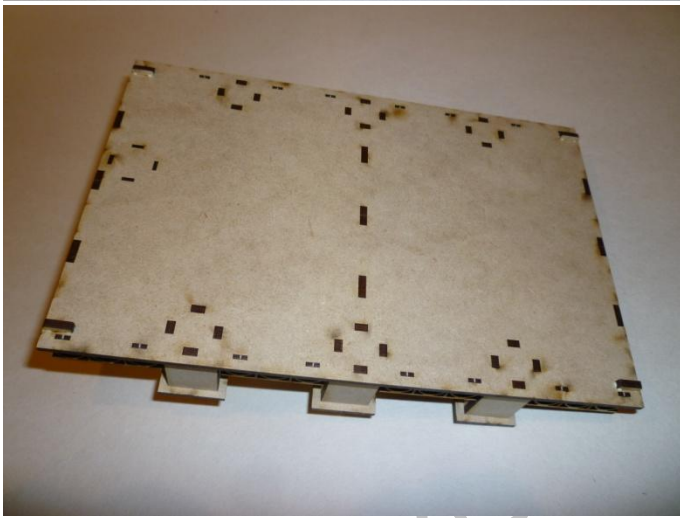
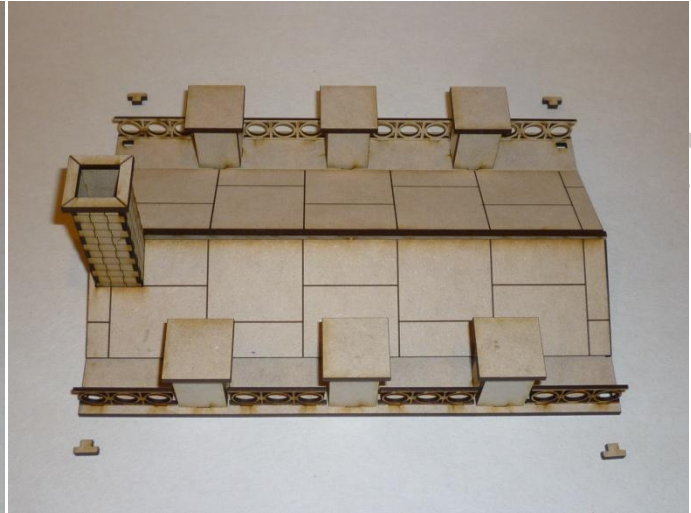
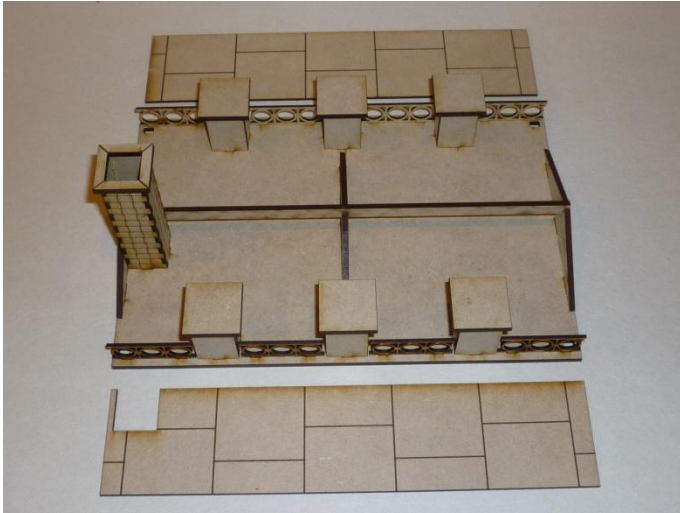

## Hallway 2:

Repeat all steps as described for Hallway 1. Just keep in mind that this tower is a mirrored version of Tower 1!

# Master Builder Series



Things from the Basement, LLC  
Dollhouse & Wargaming Miniatures

## Final stuff:

### *Clock*

Glue two dial pieces back to back and insert into wall mount. Add hands (optional).

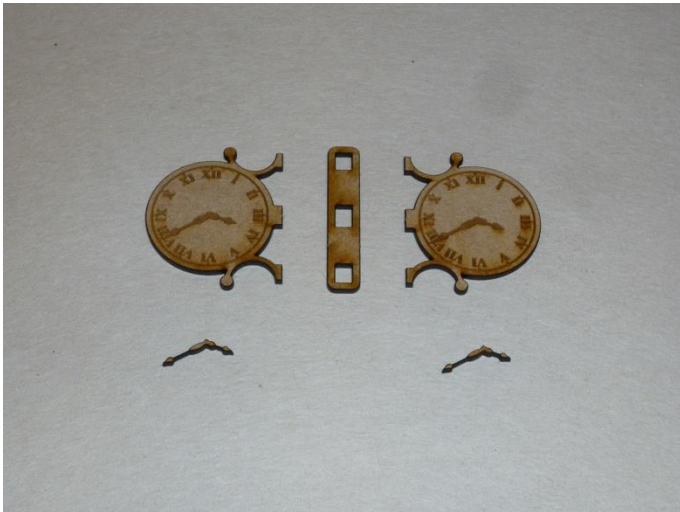

### *Phone booth*

Prepare phone booth by gluing frames and handle on the outside. Then glue walls onto base and two top pieces. Finish by adding telephone sign (no glue required).

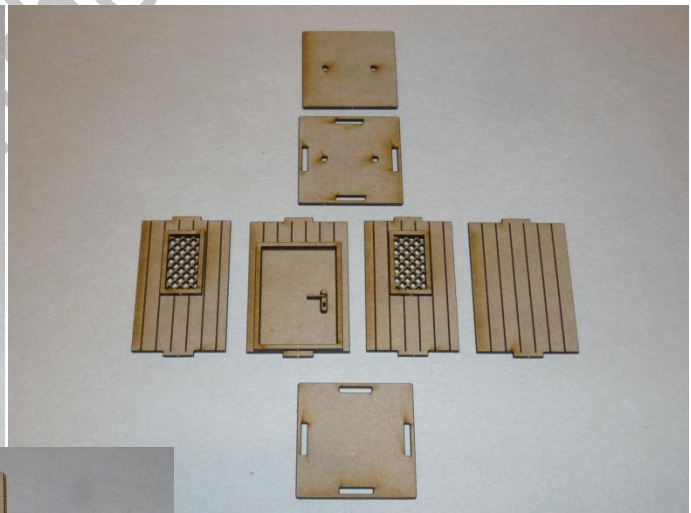
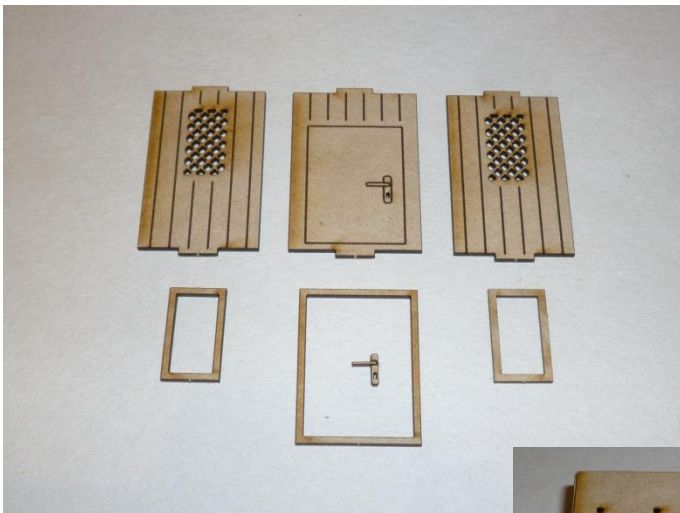



## Signs

Add signs as desired.

Train stations of this style are quite common all over Europe; therefore signs are included in three languages (French, German and Russian). Use tacky glue if you want to be able to exchange the signs.

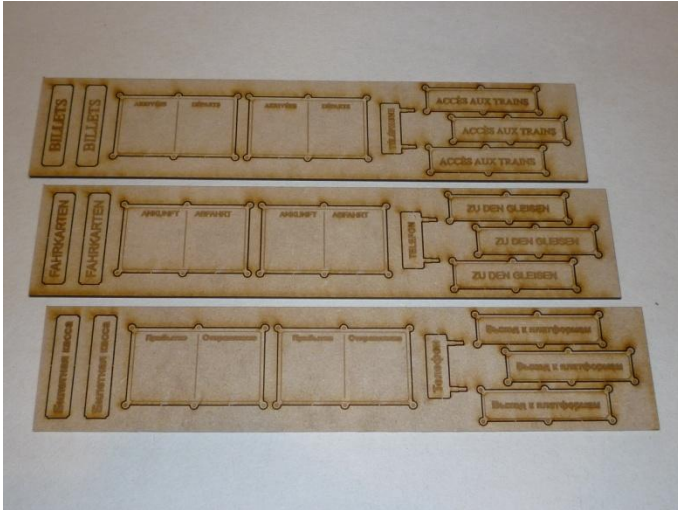

Translation (from left to right):

- Tickets
- Arrival /departure
- Telephone
- To the tracks



If you ever experience problems or difficulties in finishing this kit don't become desperate! Just send me an email at [thingsfromthebasement@gmail.com](mailto:thingsfromthebasement@gmail.com) and I will help you get it done. Having designed the kit and then providing an instruction for everyone to understand is probably the hardest part of the whole project. I am ready for every kind of feedback to improve kit and instructions. I just need to know!

# Master Builder Series



Things from the Basement, LLC  
Dollhouse & Wargaming Miniatures

Photos of finished kit:

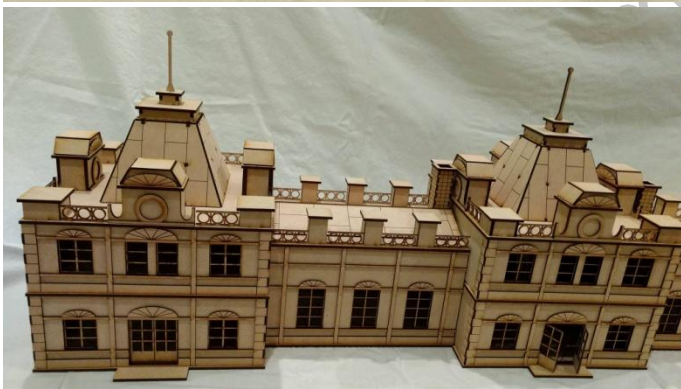
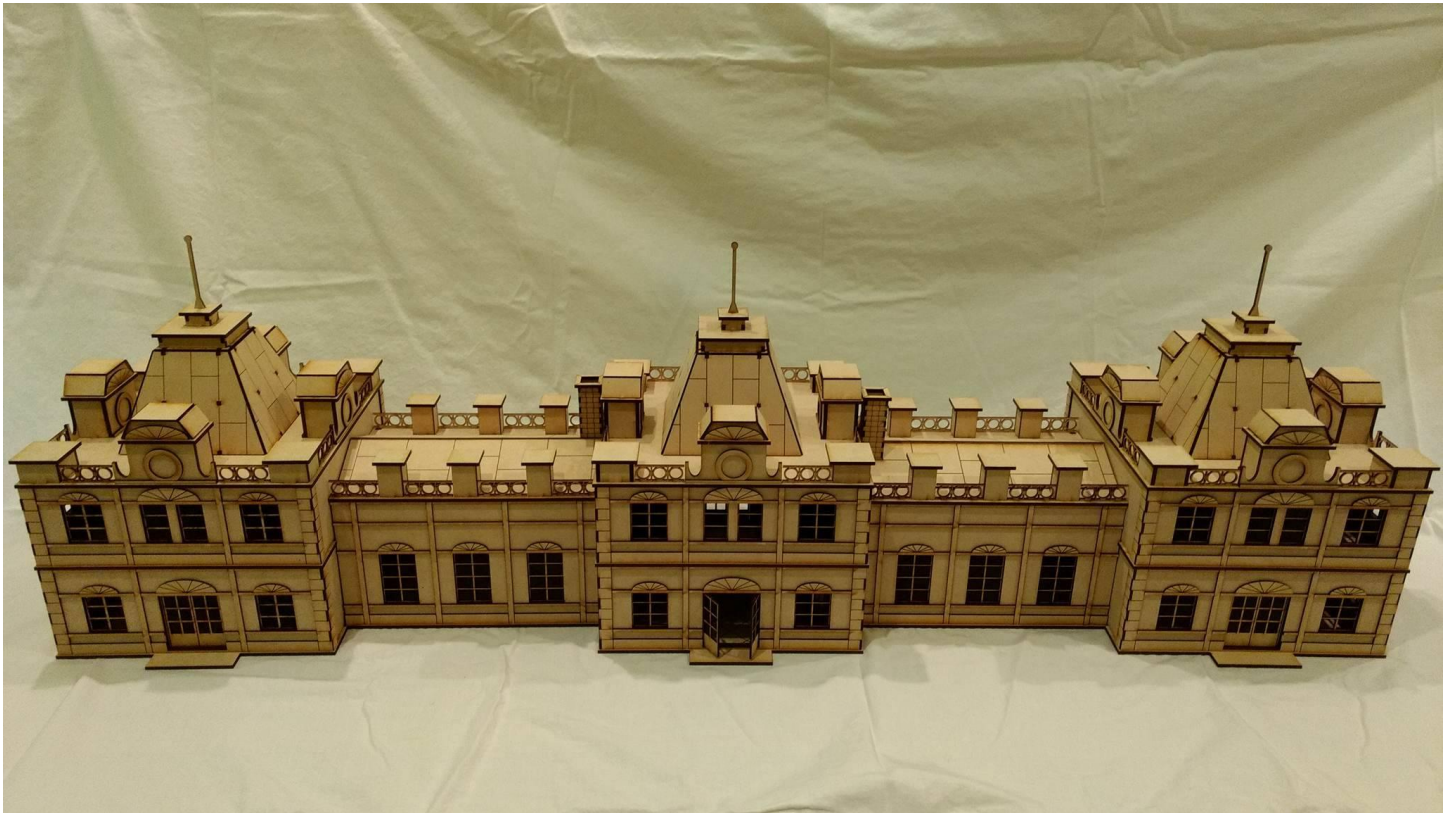



# Master Builder Series



Things from the Basement, LLC  
Dollhouse & Wargaming Miniatures

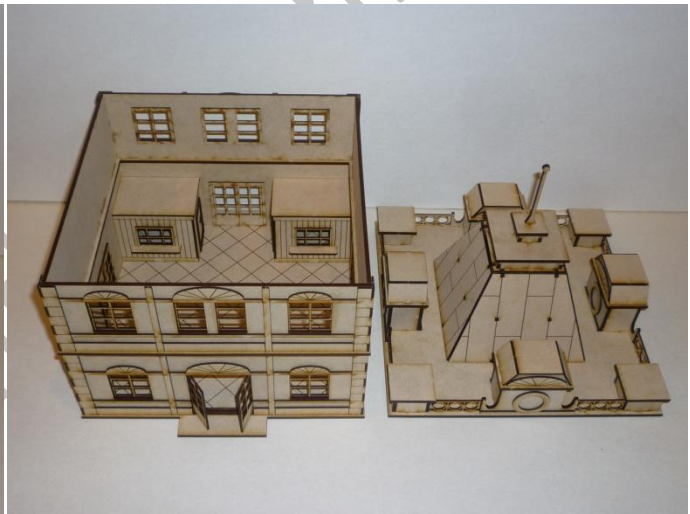
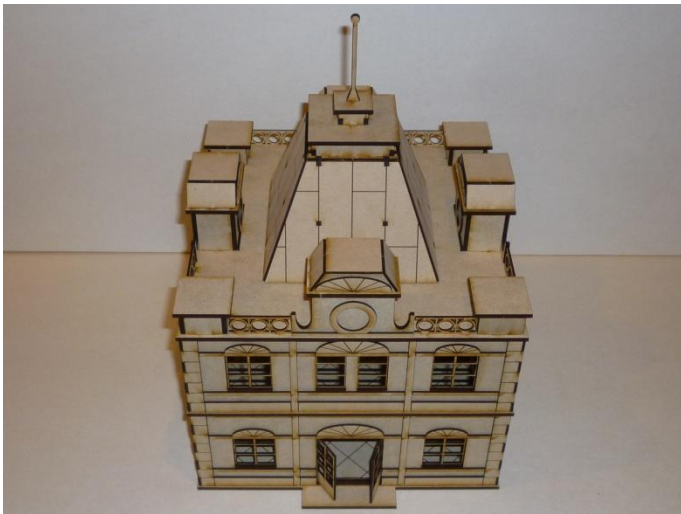
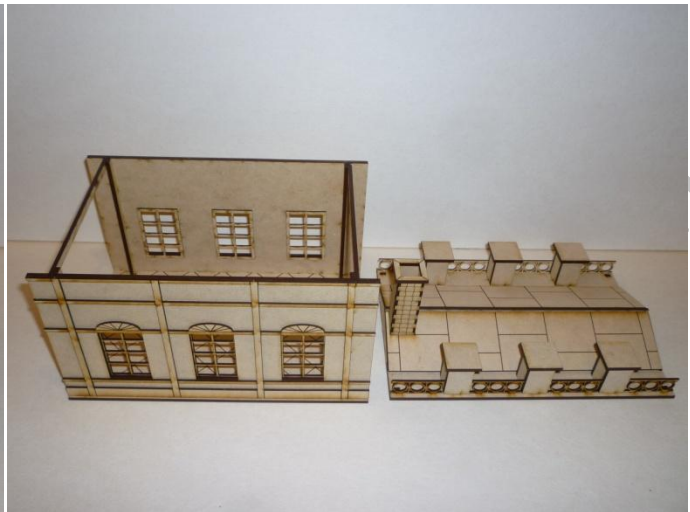

www.thingsfromthebasement.com