

Industrial

Modular Warehouse - Front

Please read the instructions before starting construction.

When opening the kit you will notice the smell of burned wood. This is because the parts are laser-cut, which literally means a very tight light beam burns through the material. You may also notice some soot at the cut edges. The amount of soot depends on the material used. You can considerably reduce it by gently wiping at least the bigger and easy to reach edges with a soft cloth or household tissue.

PVA or equivalent glue will be required to glue parts together. Give glue enough time to dry. Wipe away any excess glue immediately using a fine cloth or the tip of a toothpick. A sharp hobby knife is needed to remove parts from the sheet. Be careful and always cut away from your body. Fine sand paper may be useful to clean these areas or any tight fitting joints. Clamps, pegs and elastic bands may help during the construction of the kit. Make sure that the parts are aligned correctly before applying any of these tools.

General pre-assembly preparations

You will achieve the best results in finishing this kit when you follow the steps listed below. Always double check with the provided pictures before gluing parts together and moving on to the next step.

Please keep in mind that - in general - engraved sides of parts are considered "outside"; not engraved sides are "inside" or positioned less visible once the kit is finished.

Assembly

X-frame support:

Glue the four X-frame pieces onto the base as shown. Then add the top. Set aside and let dry thoroughly!

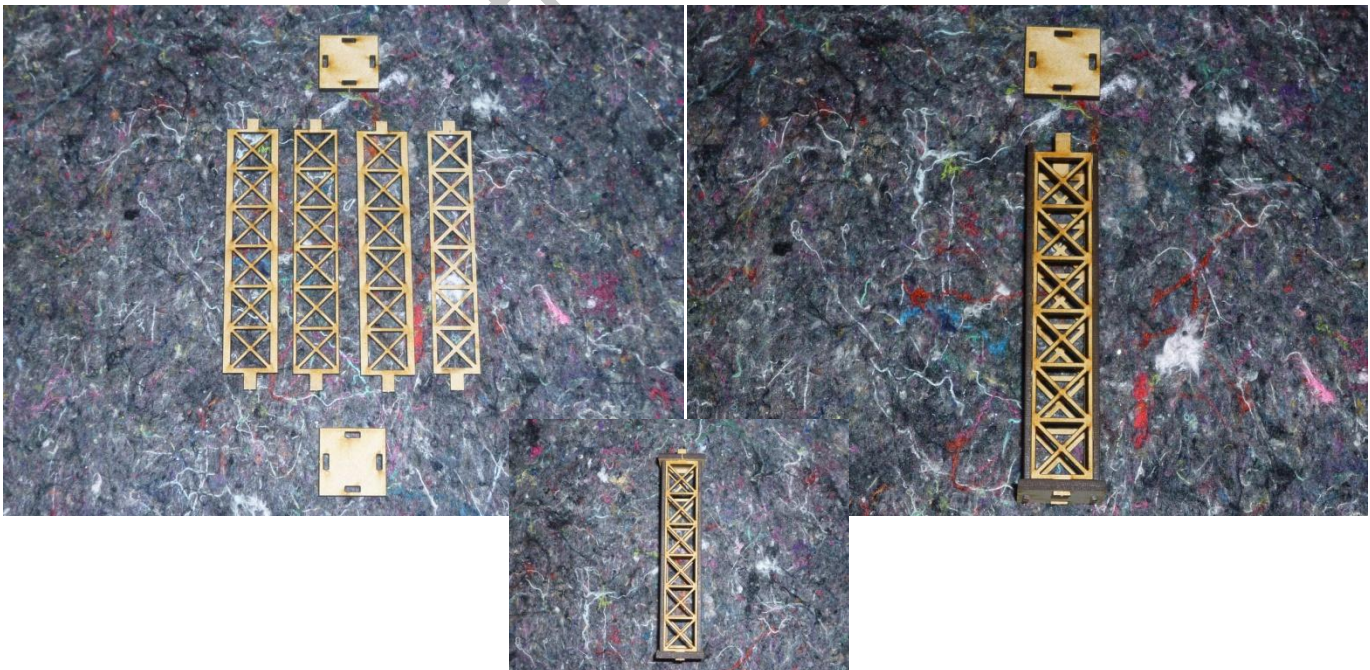

Industrial

Base:

Tip: Due to technical reasons the base comes in two pieces. To add additional stability it is recommended to glue construction paper or packing tape on the underside overlapping the seam!

Position the two base pieces as shown. Glue the completed X-frame support in place and let dry thoroughly!

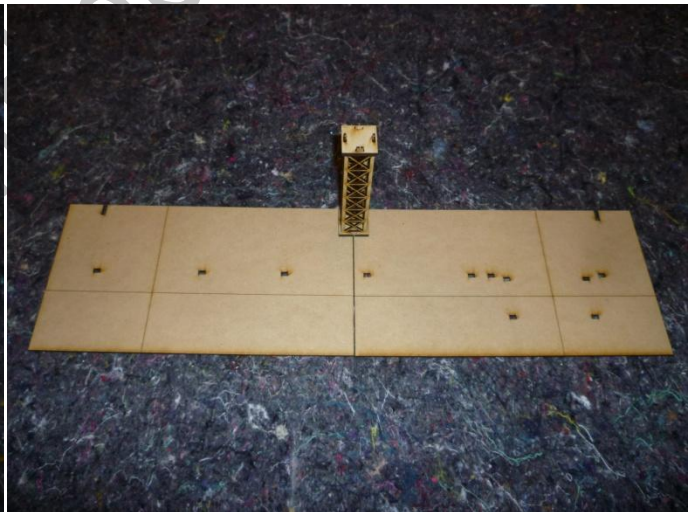
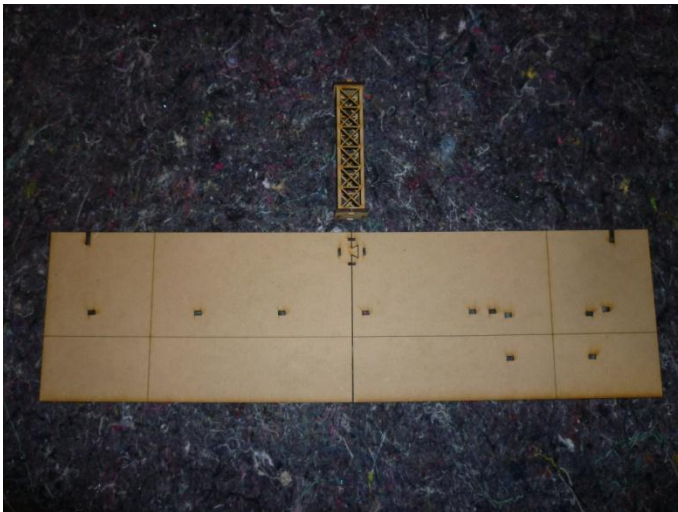
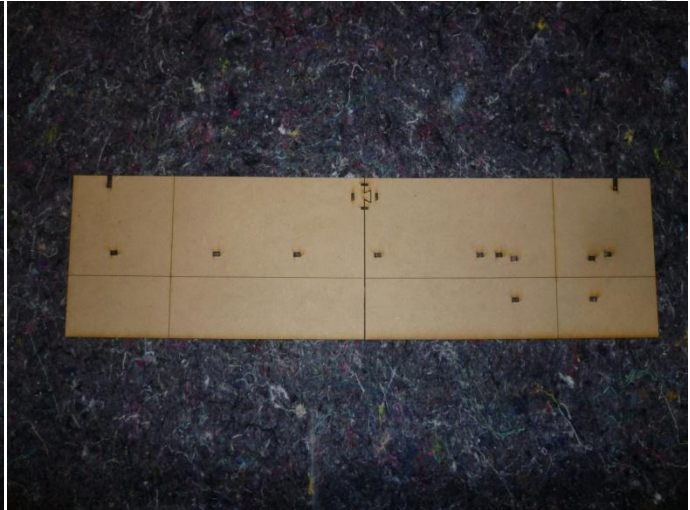
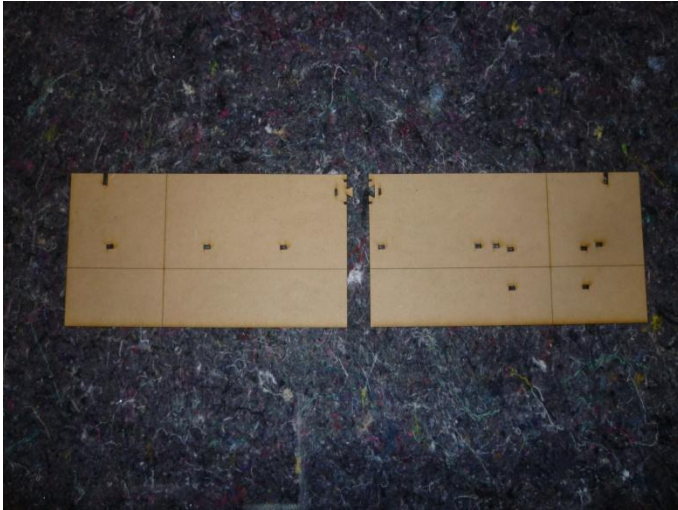

Industrial



Main Wall:

Glue the two pieces of the main wall together. Then glue roof supports in place as shown. Let dry thoroughly!

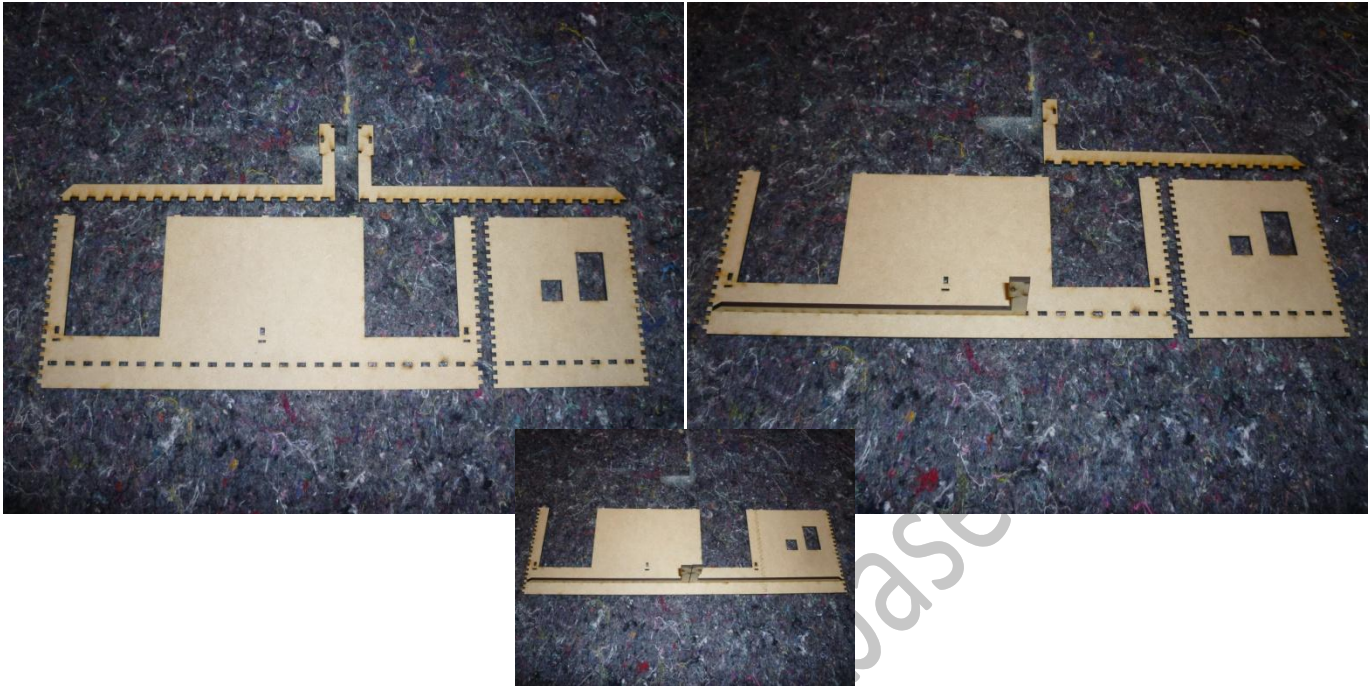

Side Walls:

Glue roof supports in place as shown. Let dry thoroughly!

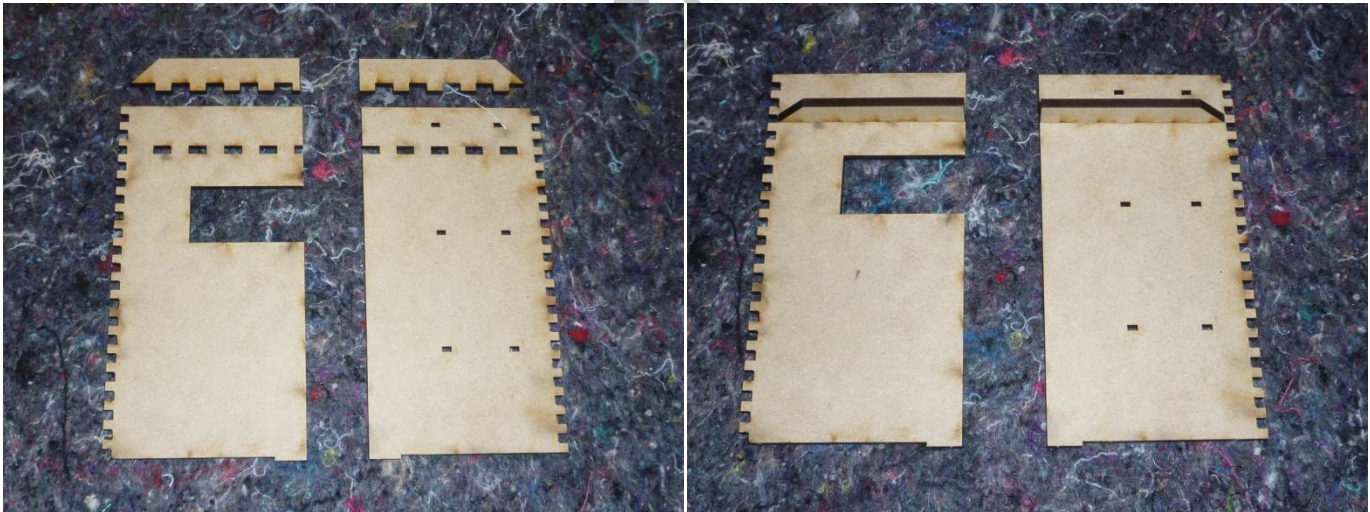

Industrial

Office steps:

Glue office steps together as shown and set aside.

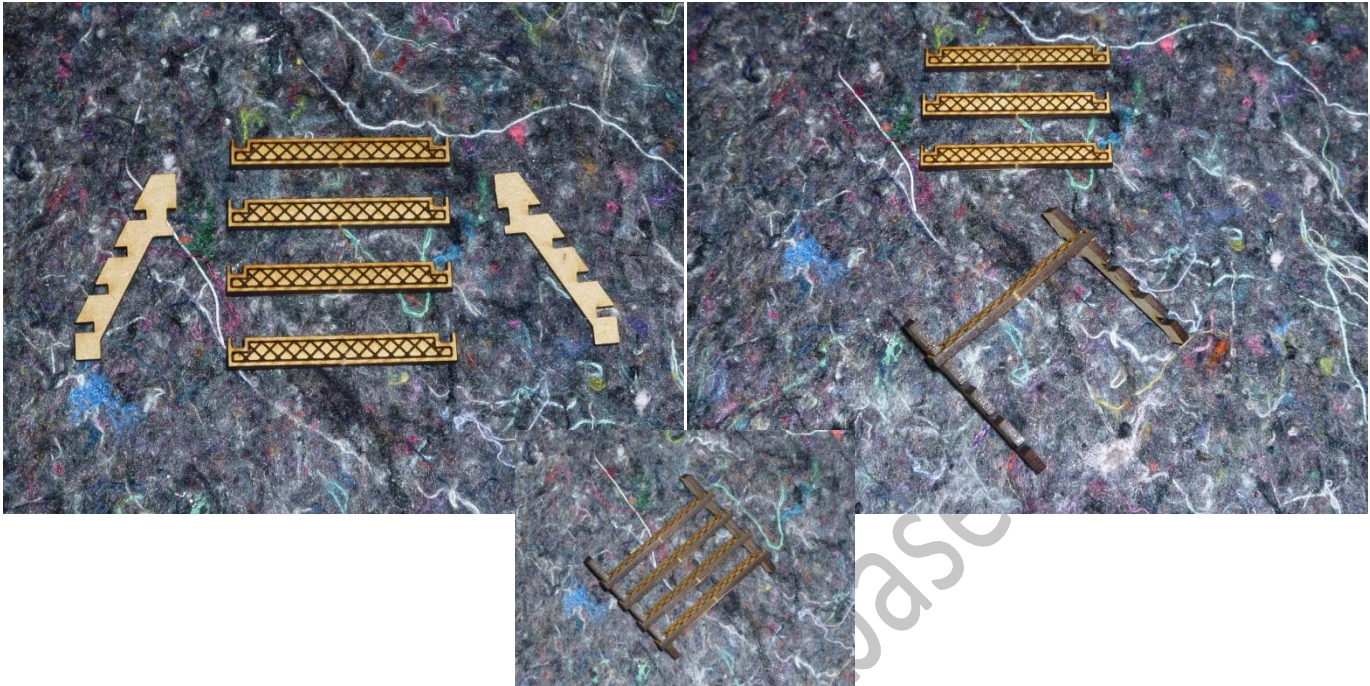

Doors:

Glue door handles onto front side. Turn door around and repeat on the inside. Set doors aside.



Industrial



Window:

Glue window on inside of wall.

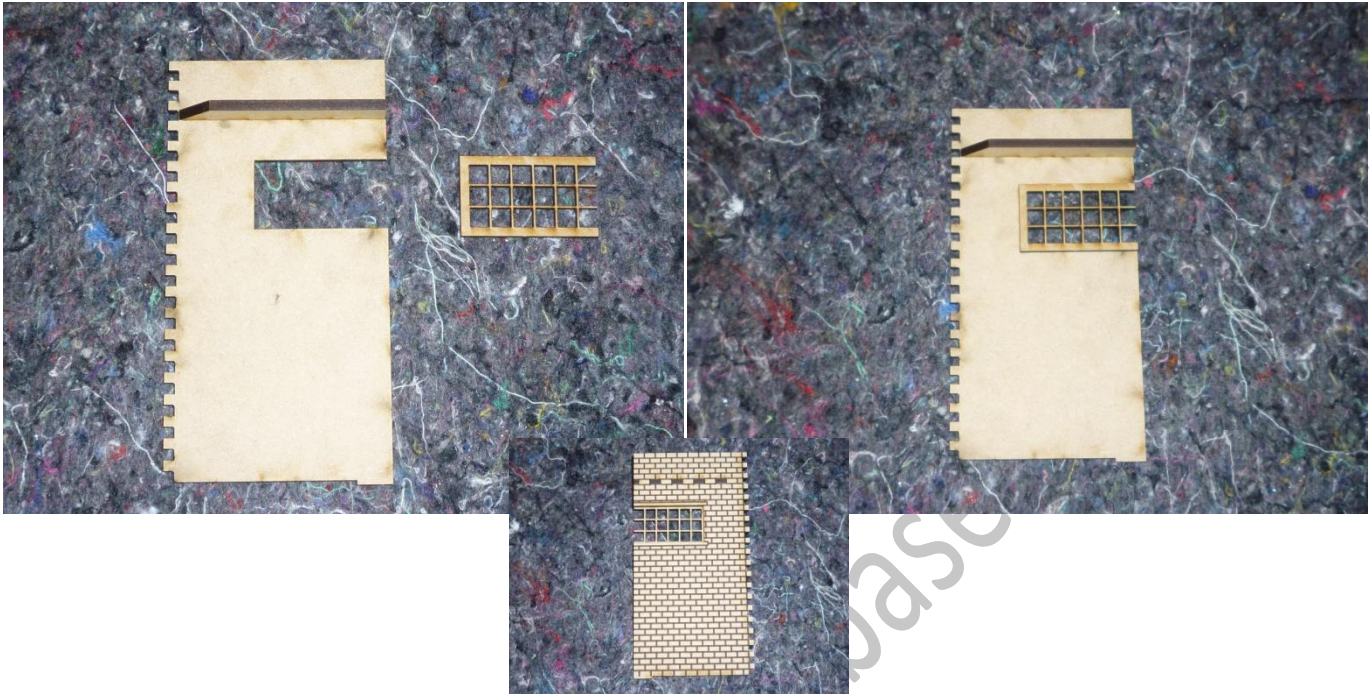

Sliding Doors:

Glue the hanging mechanism in place as shown. Then add the two door handles. Repeat for second sliding door.



Industrial

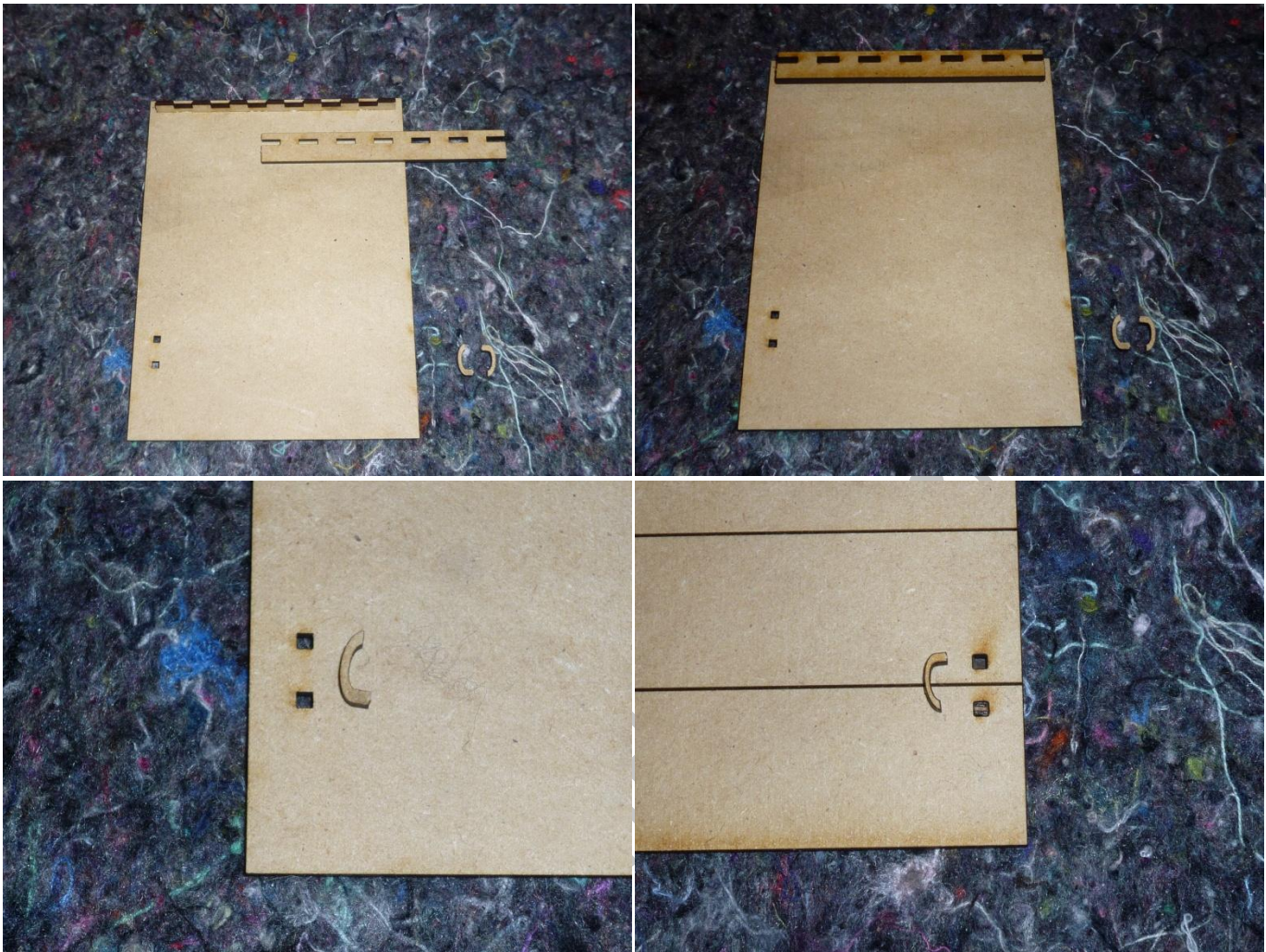

Sliding Door Frames:

Glue the interior framing of the sliding doors in place as shown



Industrial

Walls:

Glue the main wall on the base. Then add the two side walls. Use clamps or elastic bands to hold the pieces in place until the glue has dried.

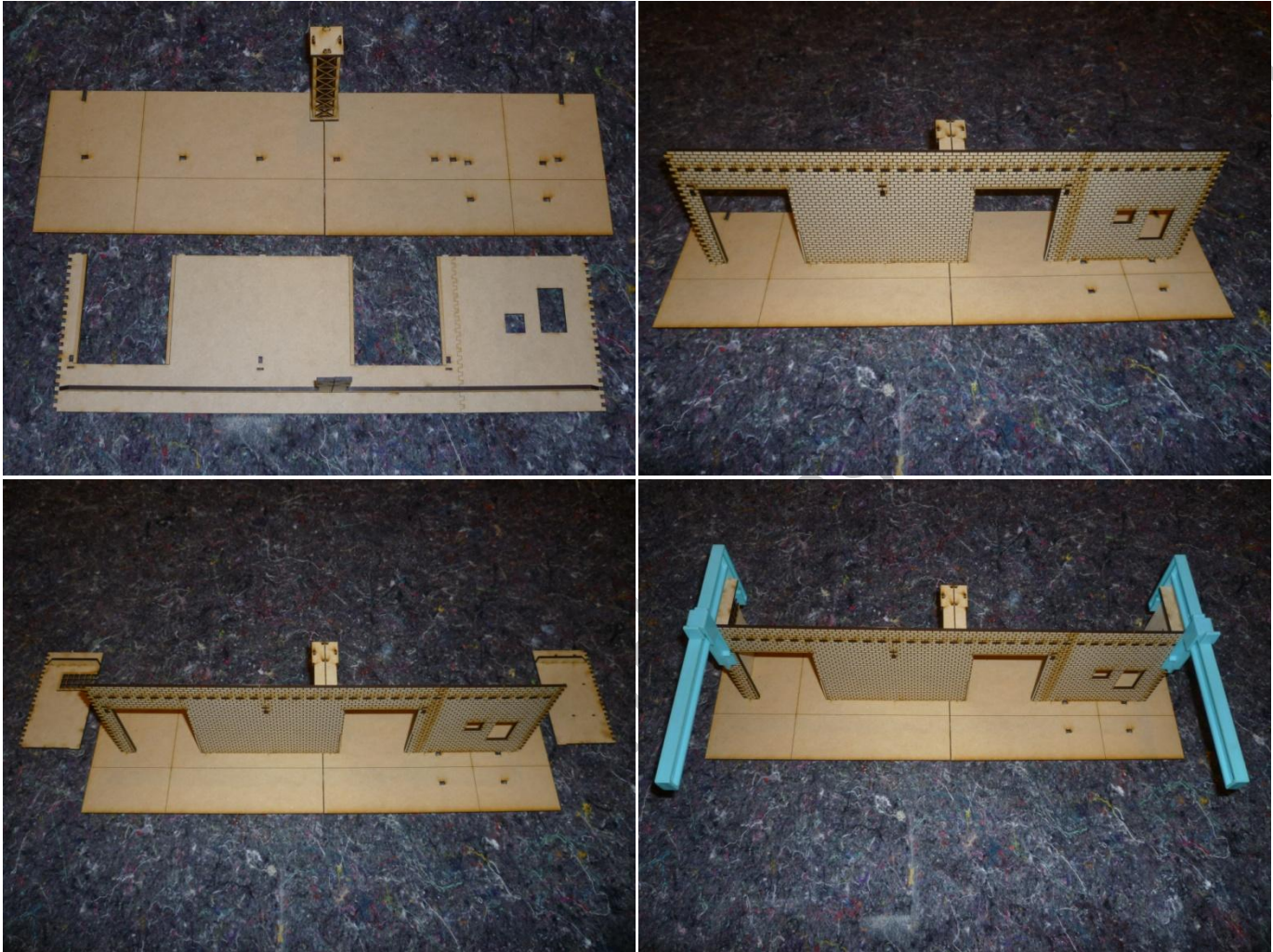

Office:

Glue the office base together as shown. Then add the two walls.

Note: *There was a design change (office window added) after the pictures were taken so the final appearance will be slightly different!*

Add door and windows frames. Finally glue office door in place as desired.

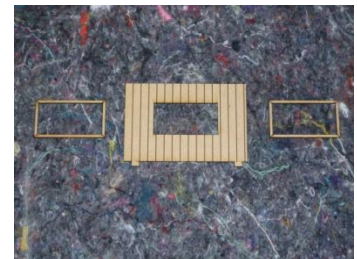

Industrial



Buildings On A Budget by
Things from the Basement, LLC
Dollhouse & Wargaming Miniatures

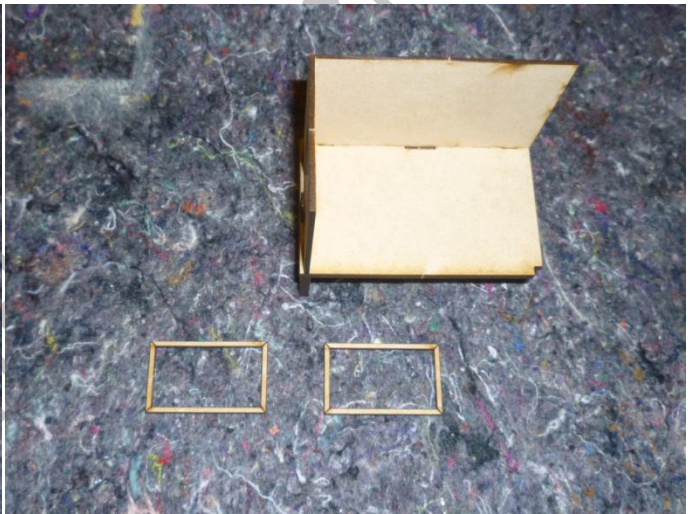
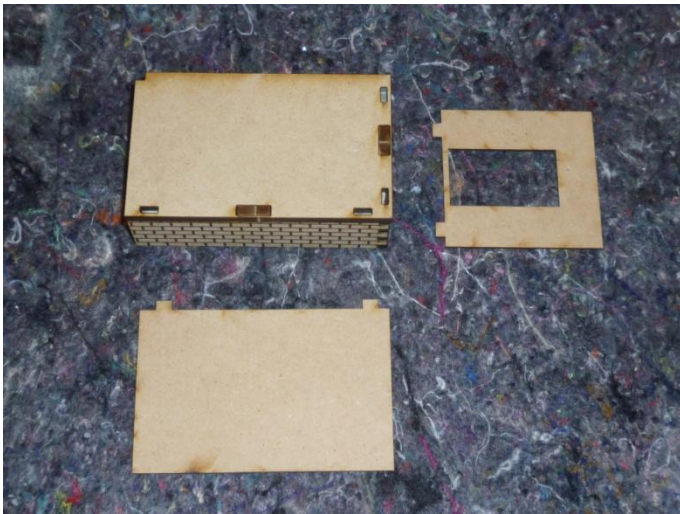
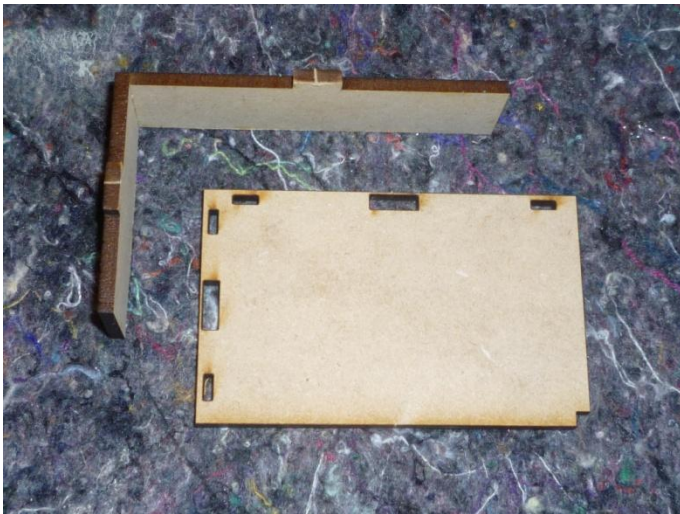

Industrial

Glue door and window frame in place as shown. Add office roof support in corner. Glue completed office into place.

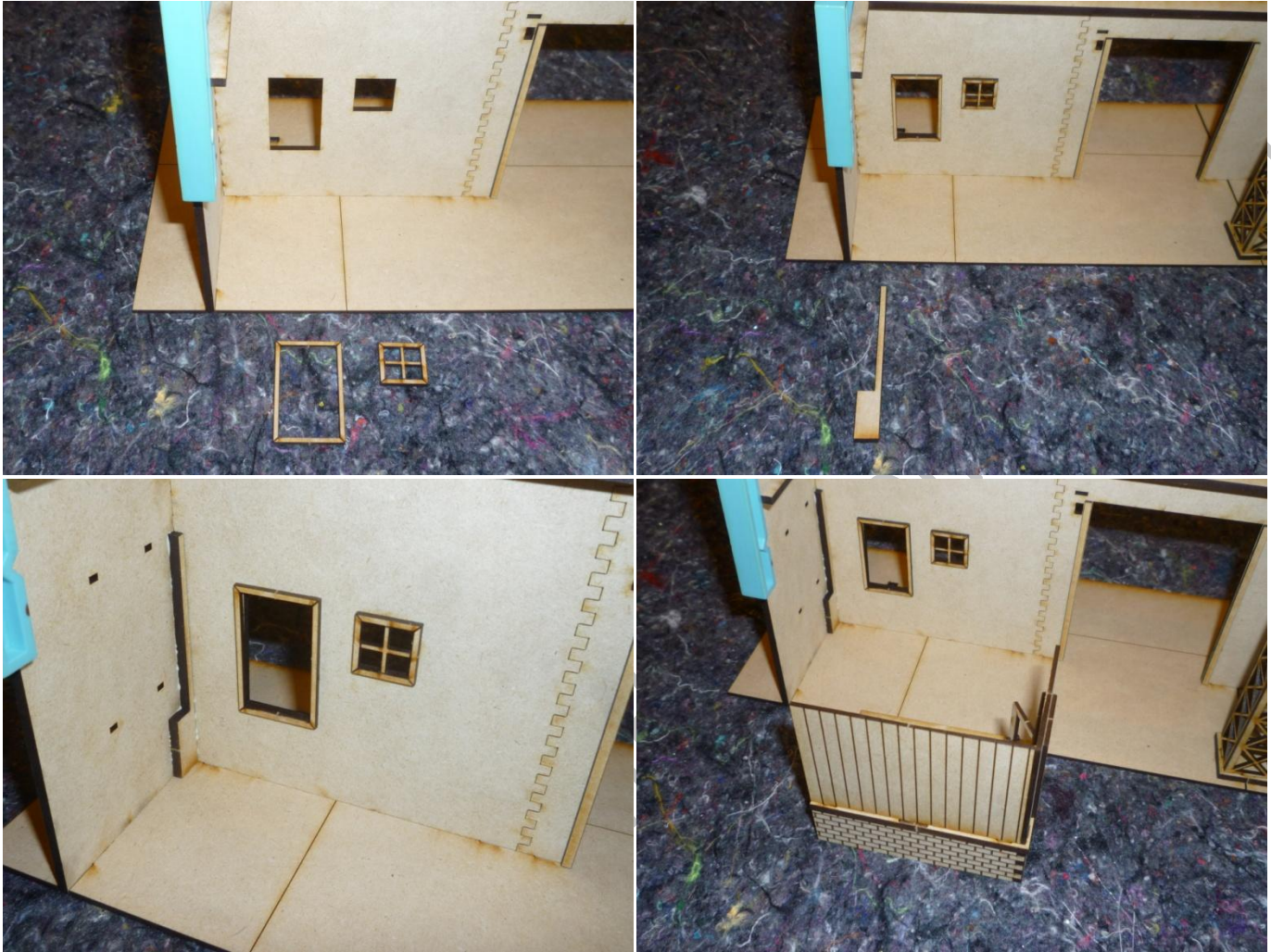

Glue two office roof pieces together as shown. Put roof on office (no glue required).

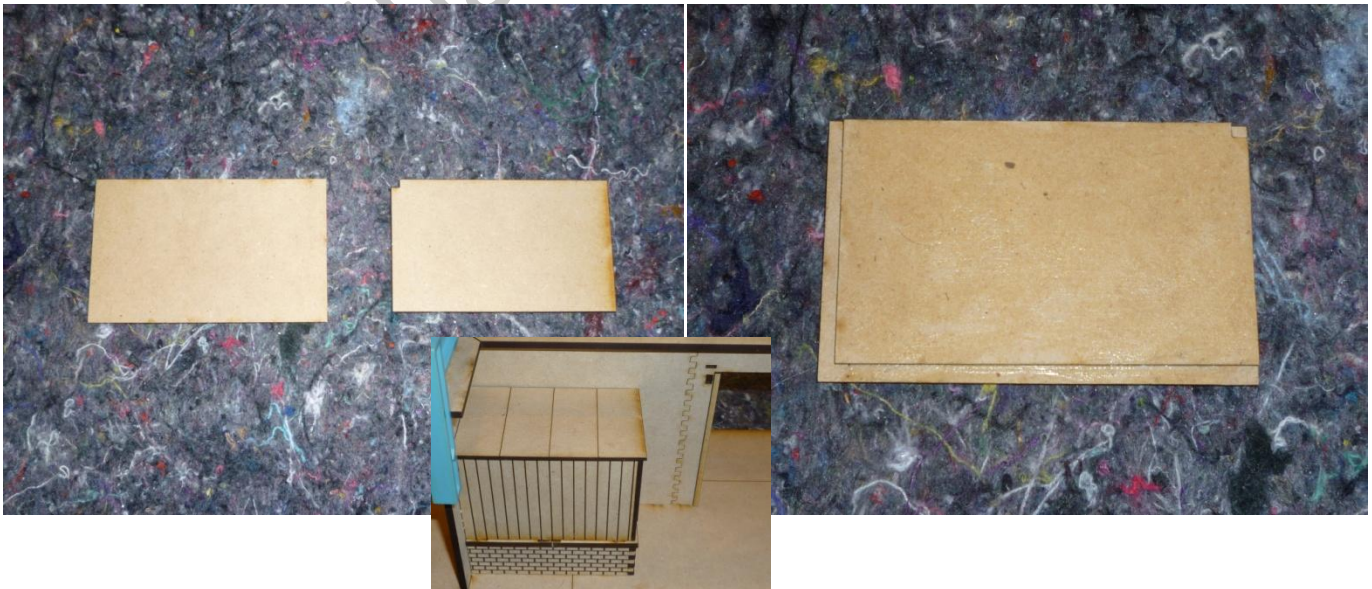

Industrial

Add office steps.

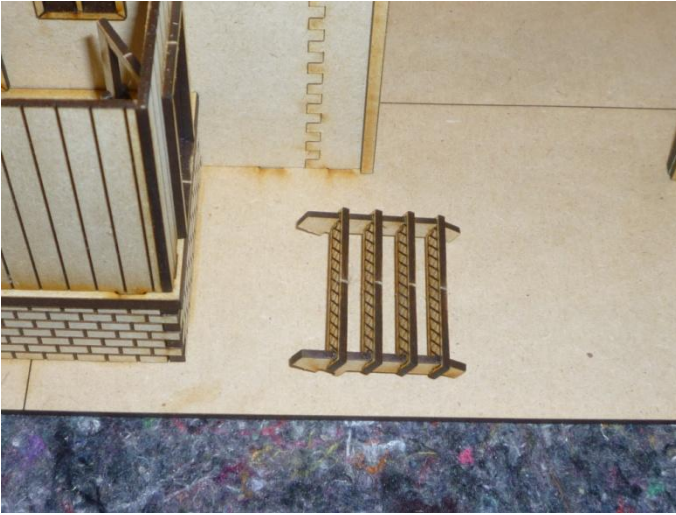

Sliding Doors:

Glue office front door in place as desired.

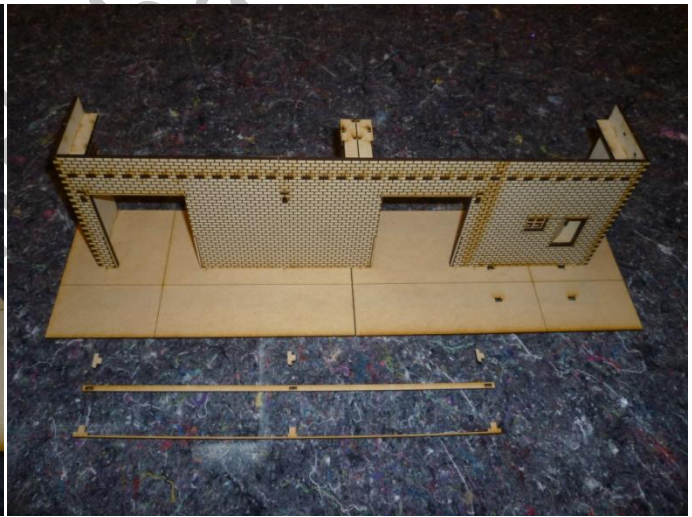
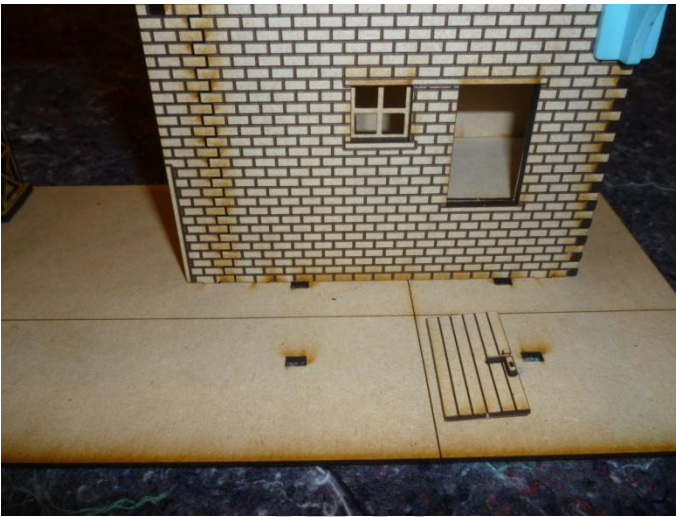

Glue three sliding door rail supports in place as shown.

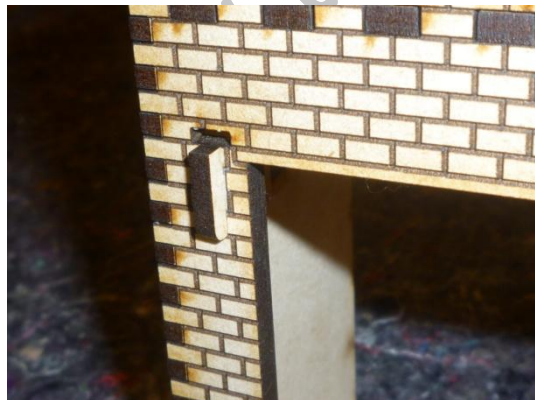

Industrial

Glue rail in place as shown. Secure by gluing in support piece on inside.



Stairs

Glue three stair pieces onto base. Then add treads and platform as shown in picture.
Then glue railing in place.

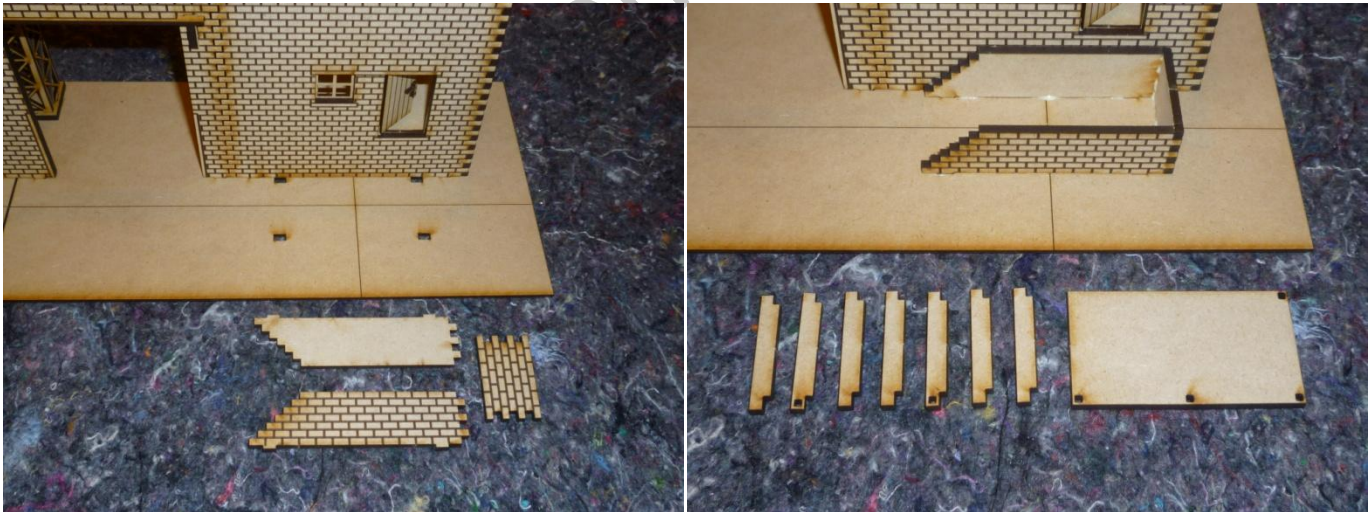

Industrial



Buildings On A Budget by
Things from the Basement, LLC
Dollhouse & Wargaming Miniatures

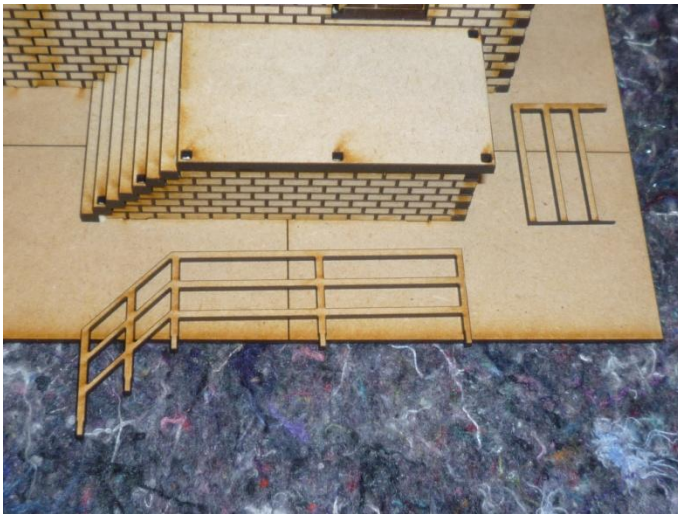

Cap Stones and Roof:

Place cap stones as shown and glue in place. Then glue two roof pieces in place. Hang sliding doors on rail.

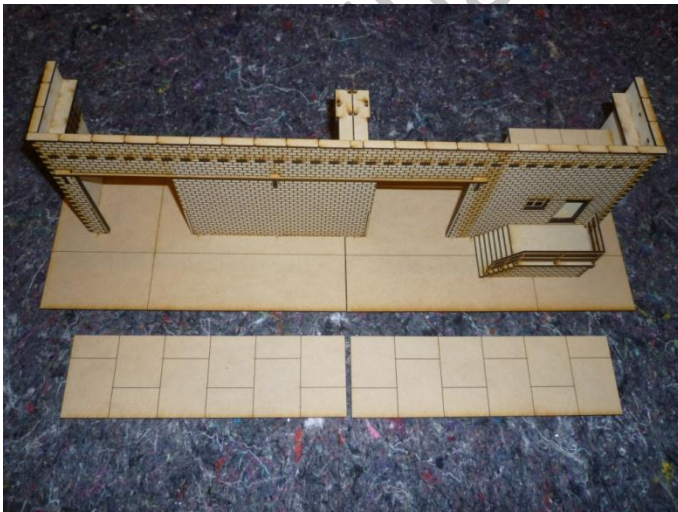
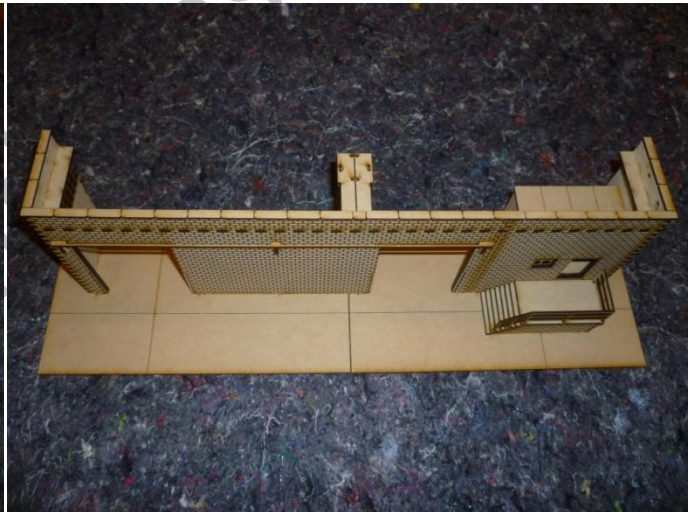
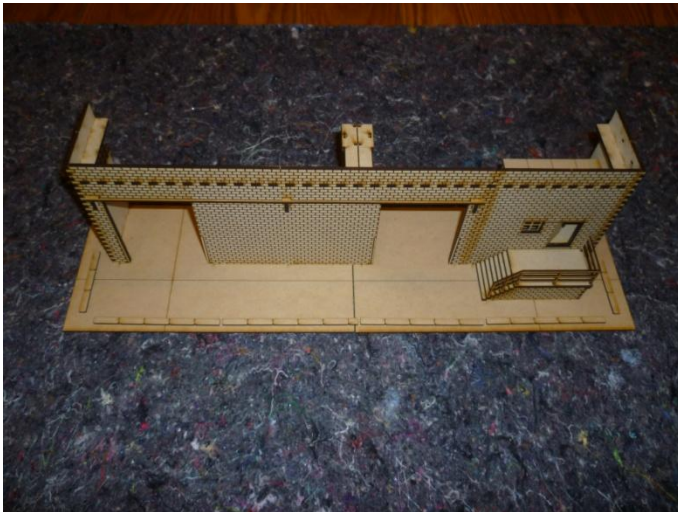

Industrial



Roof Ladder:

Glue three rings on wall as shown. Glue ladder in place. Add vertical supports as shown. Finally add half ring at top.

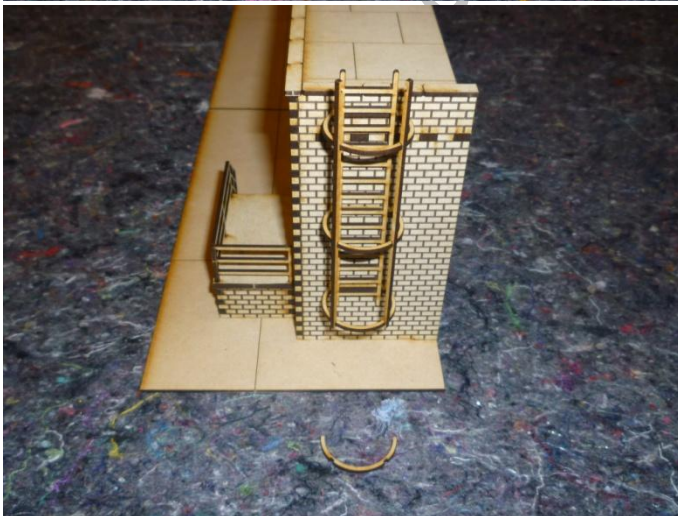
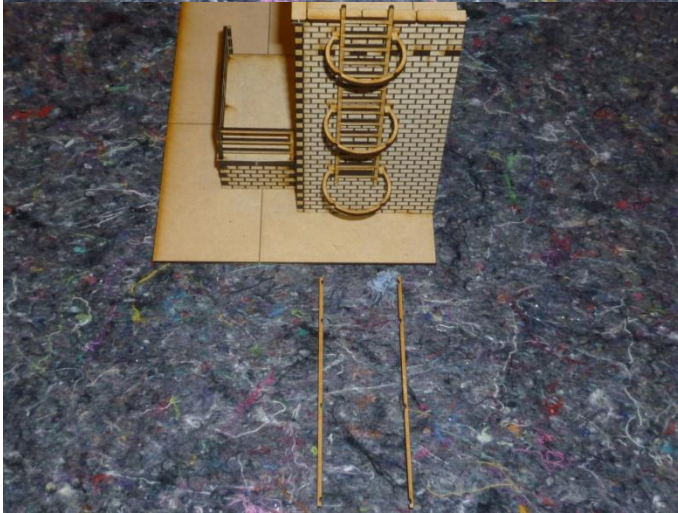
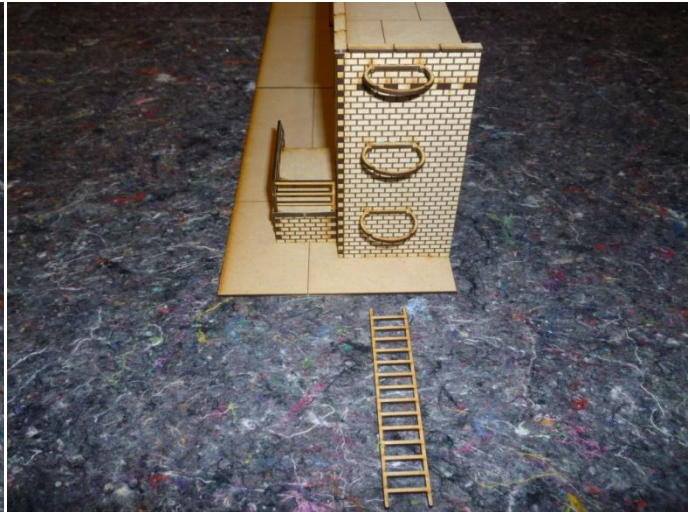
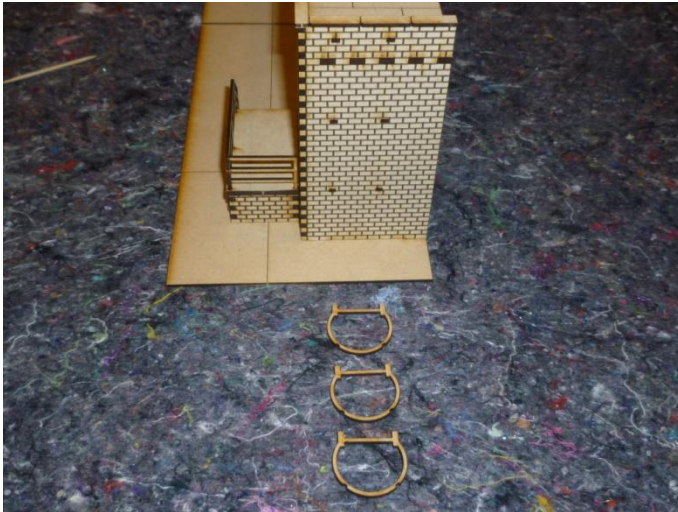

Industrial

The warehouse is designed as a modular kit.

You can add the back piece and as many middle pieces as you want!

In addition you may use the front and back pieces as low-relief buildings:

Place them at the edge of your gaming table – the open side facing outside – and bring the battle to the table edge!

If you ever experience problems or difficulties in finishing this kit don't become desperate! Just send me an email at thingsfromthebasement@gmail.com and I will help you get it done. Having designed the kit and then providing an instruction for everyone to understand is probably the hardest part of the whole project. I am ready for every kind of feedback to improve kit and instructions. I just need to know!

Photos of finished kit:



Industrial

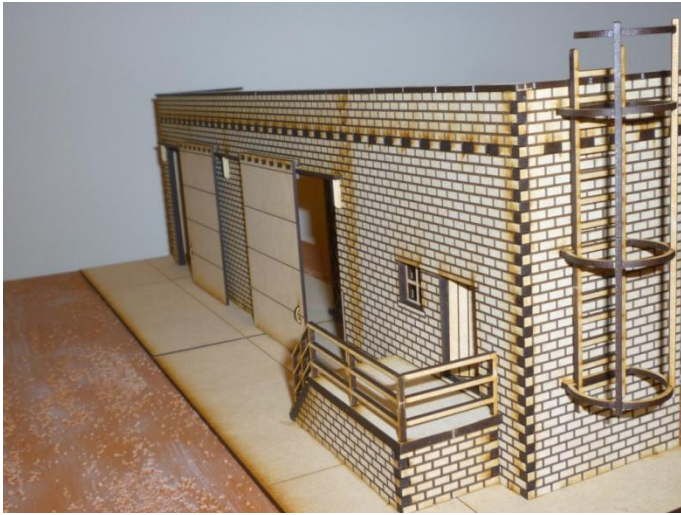

Industrial

Modular Warehouse

One (1) Middle Module



Industrial



★ **Buildings On A Budget** by

Things from the Basement, LLC

Dollhouse & Wargaming Miniatures

Two (2) Middle Modules

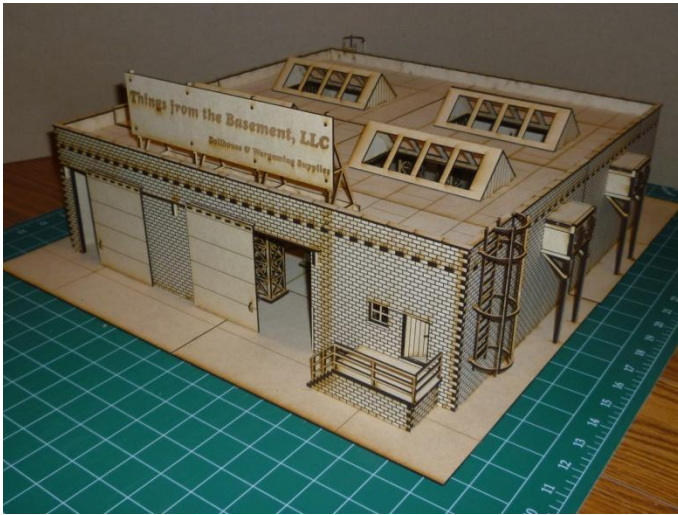

You can add as many Middle Modules as you want!

**Alternatively you can use the Front Module and the Back Module
as separate buildings placed at the table edge!**

Your individualized warehouse sign is available separately!