



Van Tassel Manor

Please read the instructions before starting construction.

When opening the kit you will notice the smell of burned wood. This is because the parts are laser-cut, which literally means a very tight light beam burns through the material. You may also notice some soot at the cut edges. The amount of soot depends on the material used. You can considerably reduce it by gently wiping at least the bigger and easy to reach edges with a soft cloth or household tissue.

PVA or equivalent glue will be required to glue parts together. Give glue enough time to dry. Wipe away any excess glue immediately using a fine cloth or the tip of a toothpick. A sharp hobby knife is needed to remove parts from the sheet. Be careful and always cut away from your body. Fine sand paper may be useful to clean these areas or any tight fitting joints. Clamps, pegs and elastic bands may help during the construction of the kit. Make sure that the parts are aligned correctly before applying any of these tools.

General pre-assembly preparations

You will achieve the best results in finishing this kit when you follow the steps listed below. Always double check with the provided pictures before gluing parts together and moving on to the next step.

Please keep in mind that - in general - engraved sides of parts are considered “outside”; not engraved sides are “inside” or positioned less visible once the kit is finished.

Assembly

1. 1st Floor

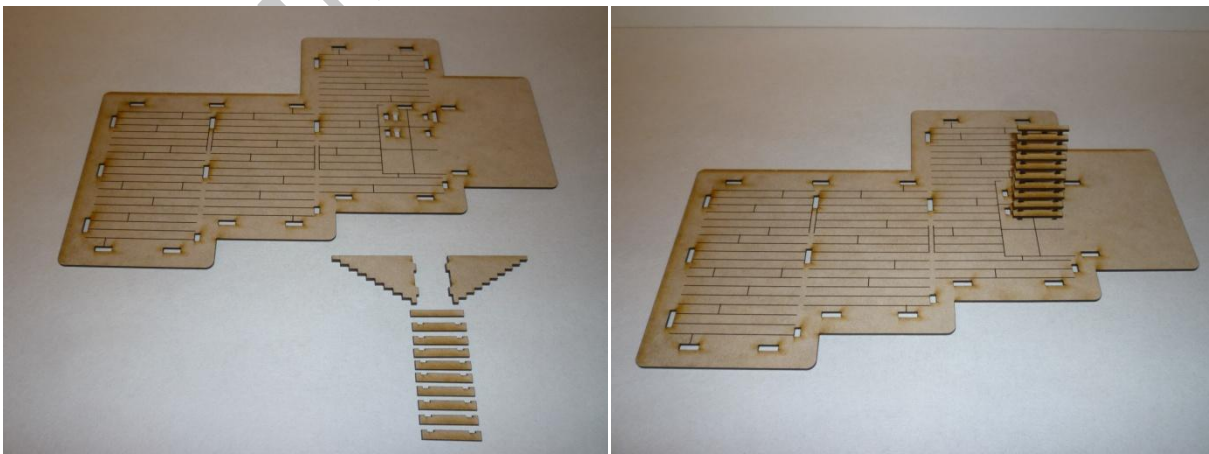



Inspired by Sleepy Hollow – The Movie

2.

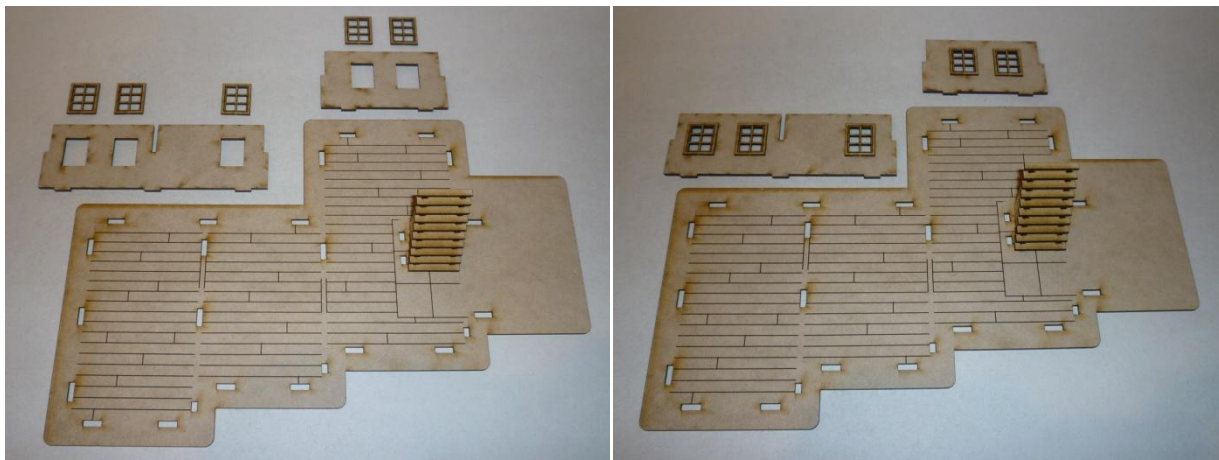

3.

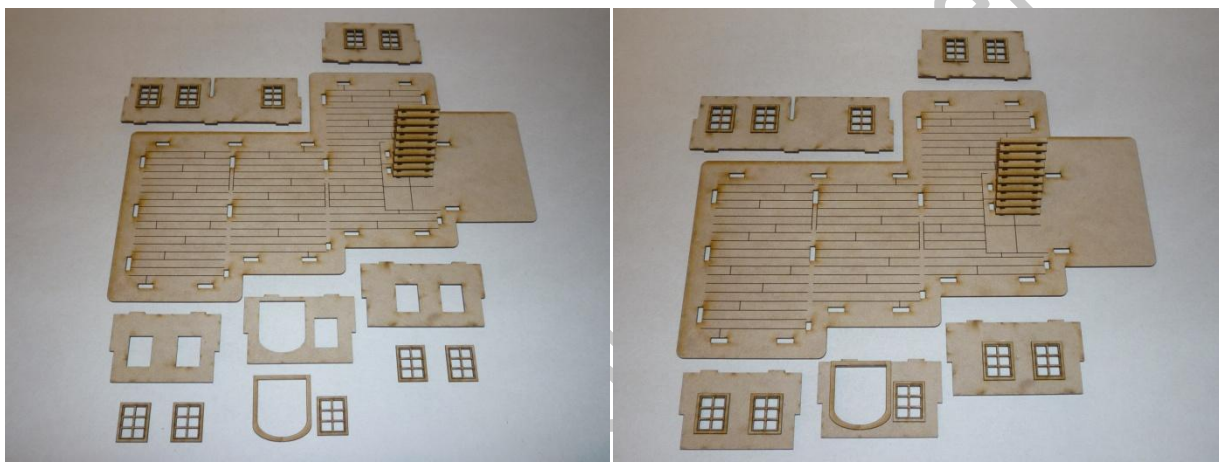

4.

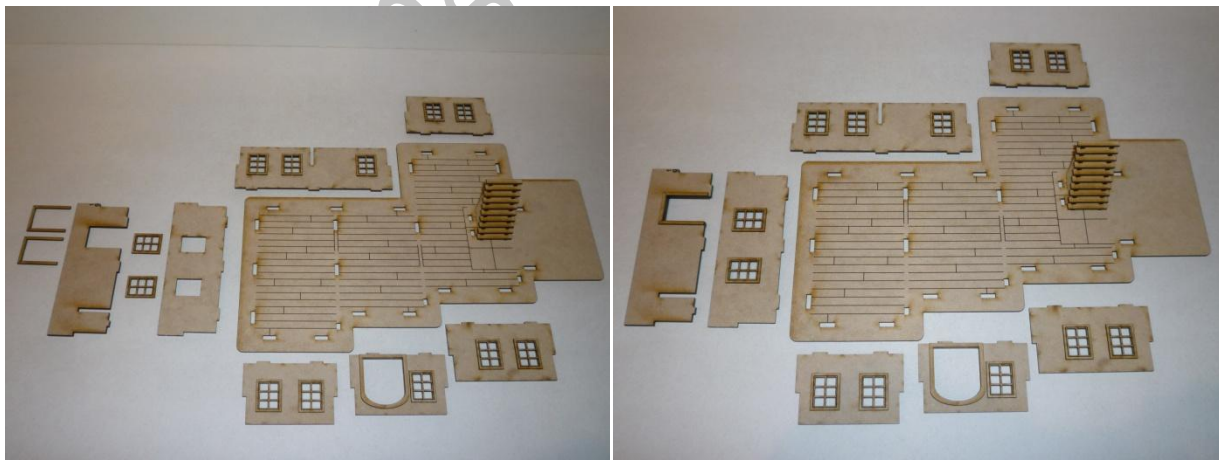

Inspired by Sleepy Hollow – The Movie



Things from the Basement, LLC
Dollhouse & Wargaming Miniatures

5.

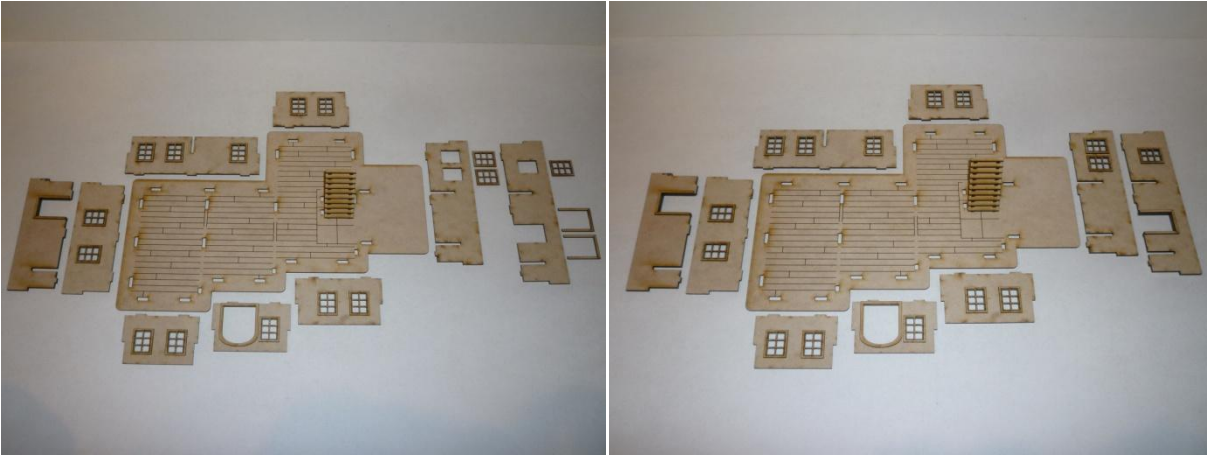

6. Match the number on the walls with the number on the base (e.g. 1A → 1A, 1B → 1B,...)

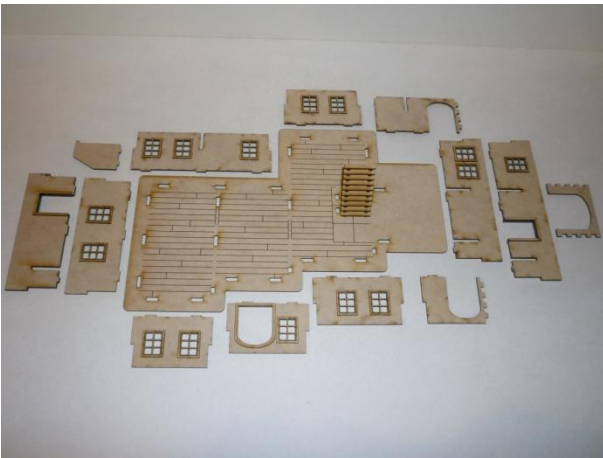

7.

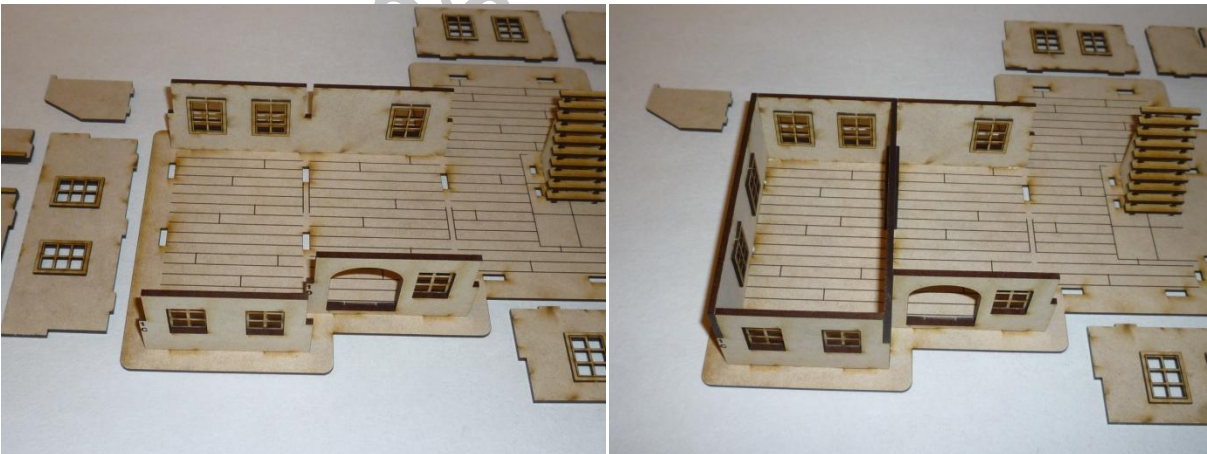

Inspired by Sleepy Hollow – The Movie



8.



9.

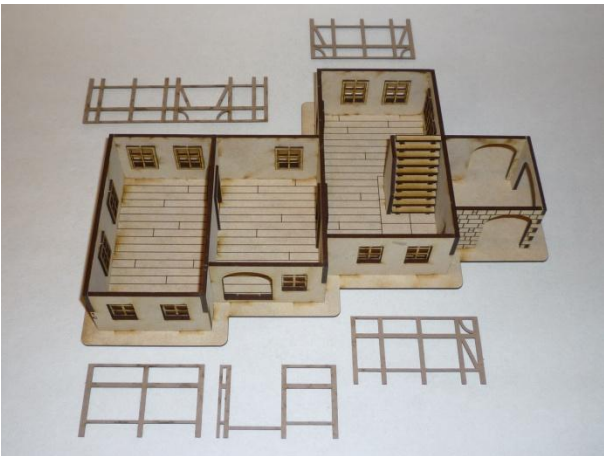

Inspired by Sleepy Hollow – The Movie



Things from the Basement, LLC
Dollhouse & Wargaming Miniatures

10.

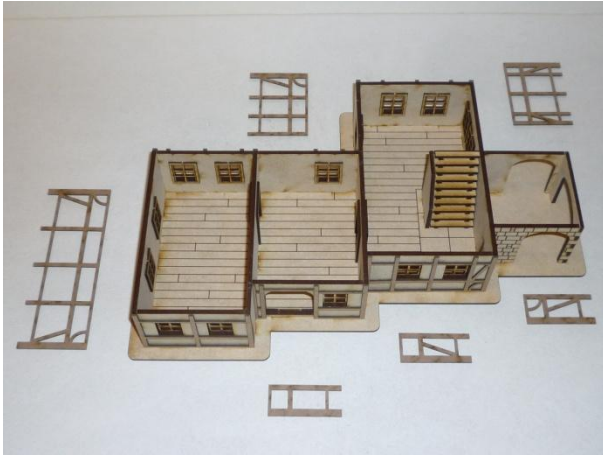

11. 2nd Floor

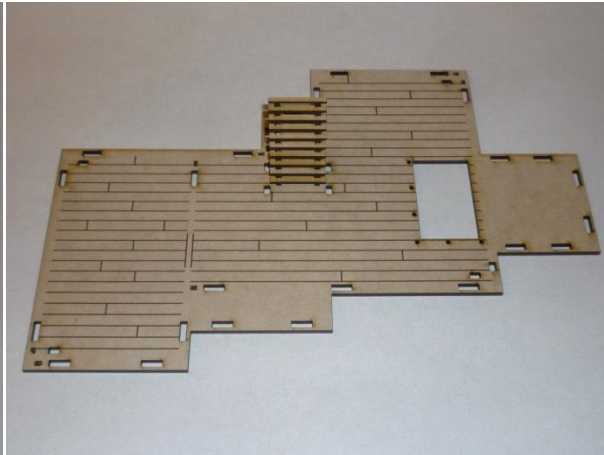
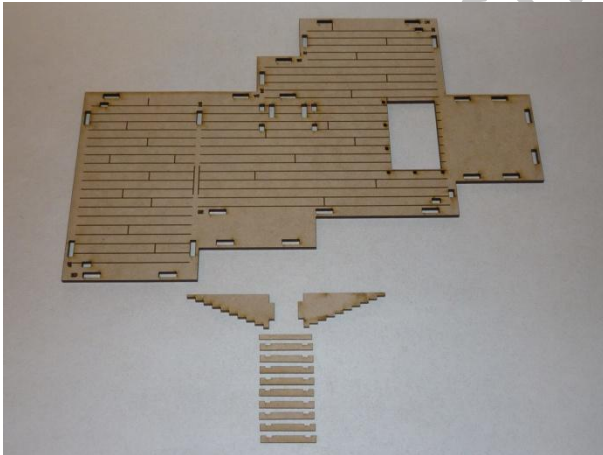

Inspired by Sleepy Hollow – The Movie



Things from the Basement, LLC
Dollhouse & Wargaming Miniatures

12.

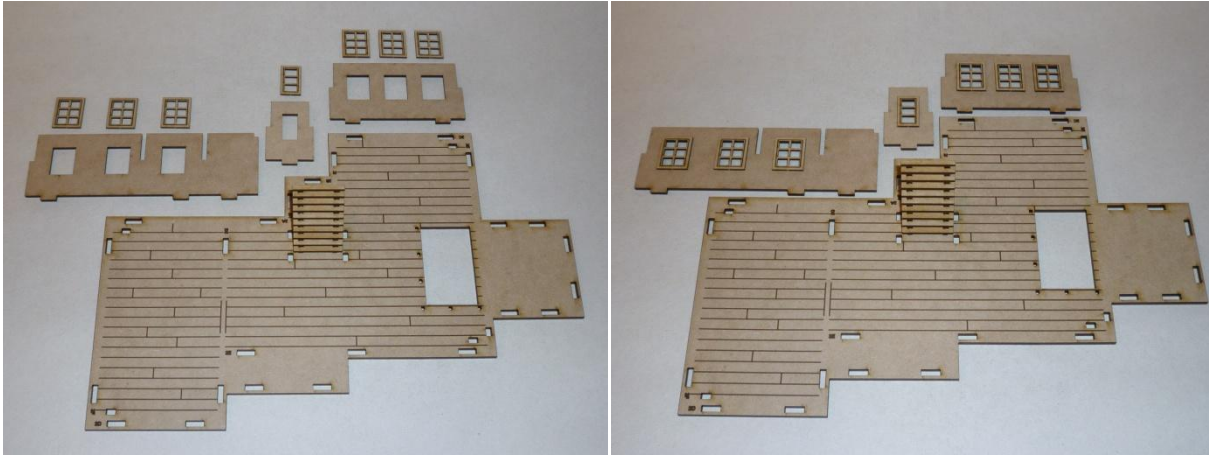

13.

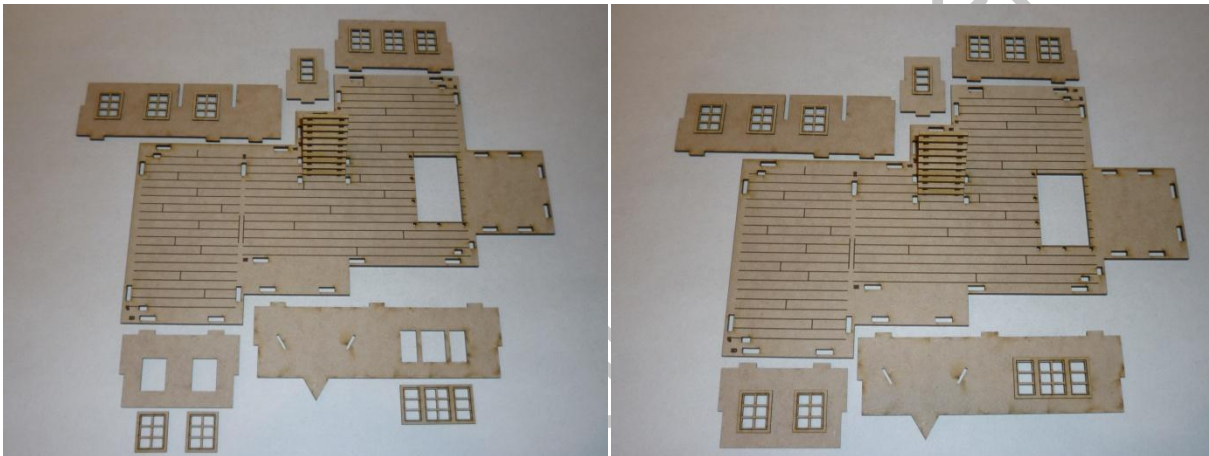

14.

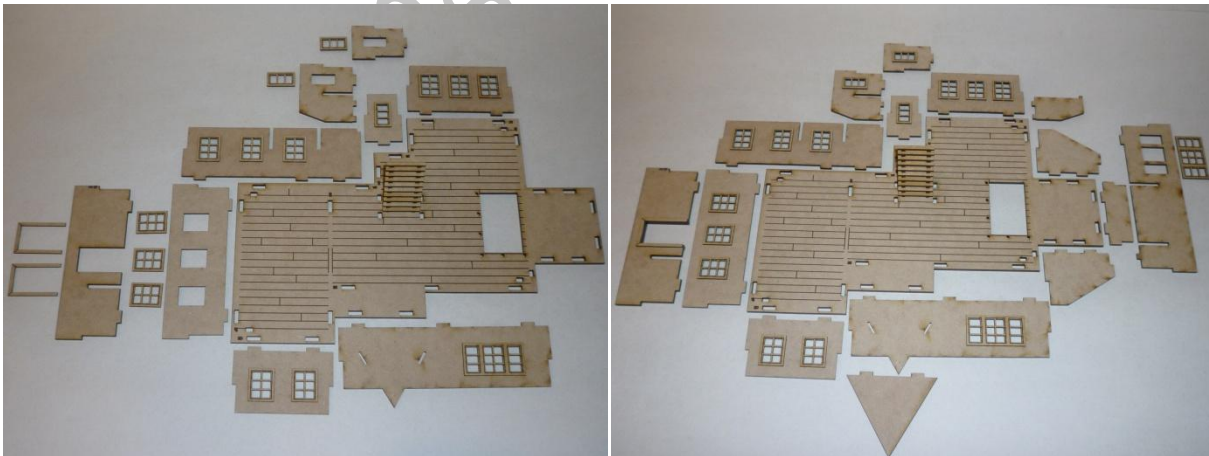

Inspired by Sleepy Hollow – The Movie



Things from the Basement, LLC
Dollhouse & Wargaming Miniatures

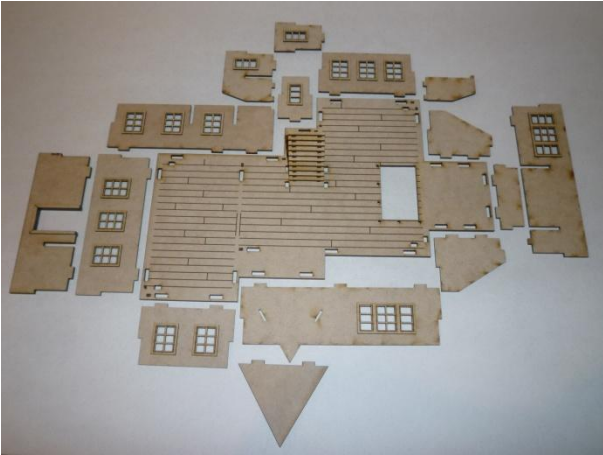

15. Match the number on the walls with the number on the base (e.g. 2A → 2A, 2B → 2B,...)

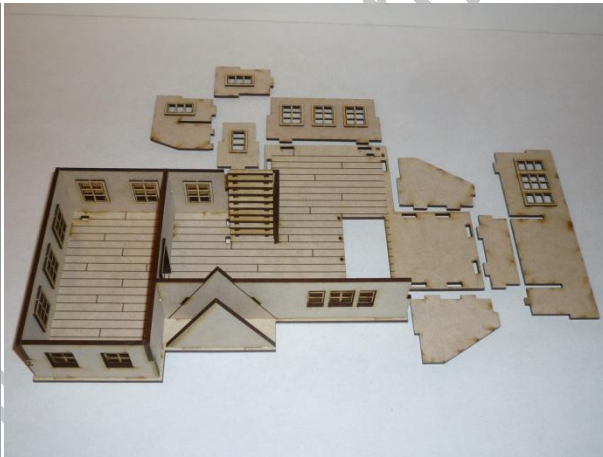
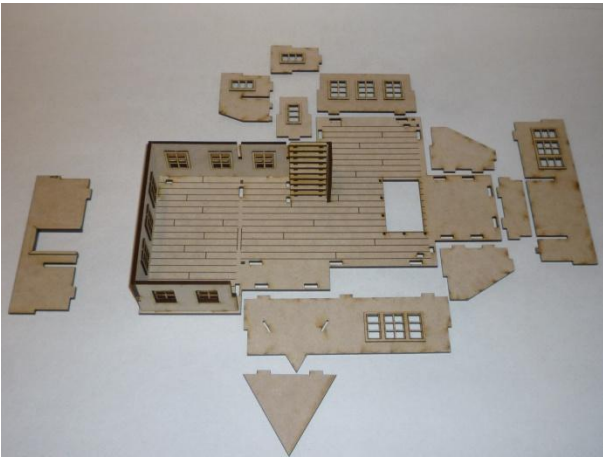

16.

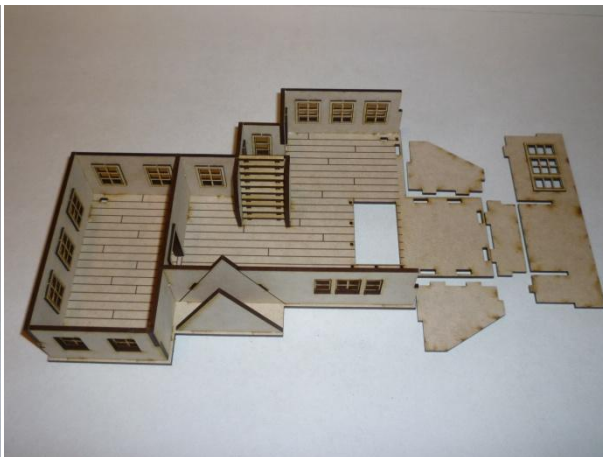

Inspired by Sleepy Hollow – The Movie



Things from the Basement, LLC
Dollhouse & Wargaming Miniatures

Errata

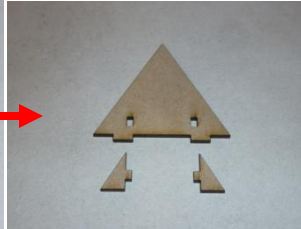
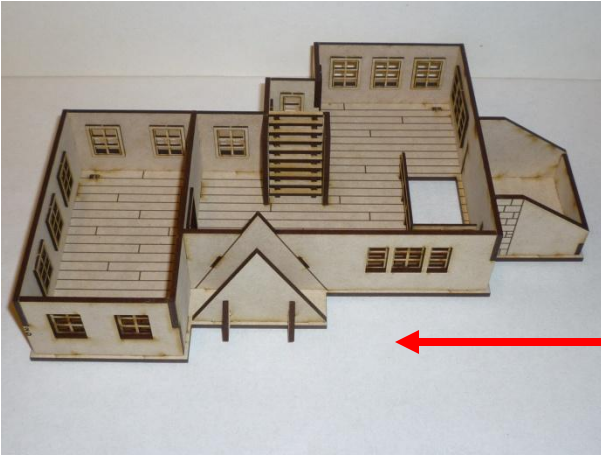

17.

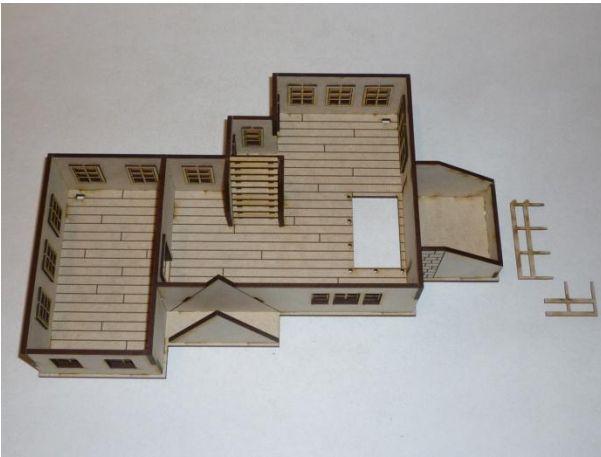

18.



Inspired by Sleepy Hollow – The Movie



Things from the Basement, LLC
Dollhouse & Wargaming Miniatures

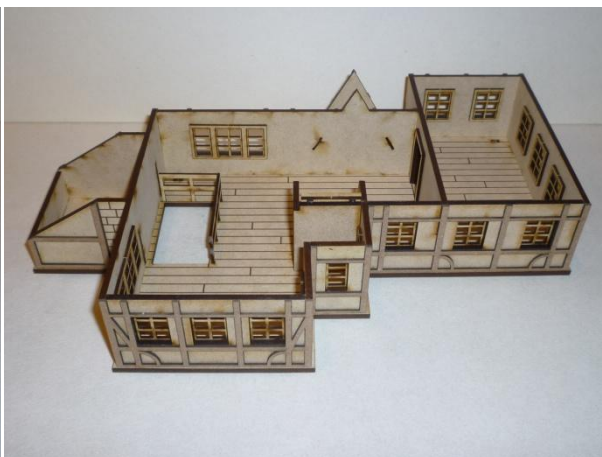
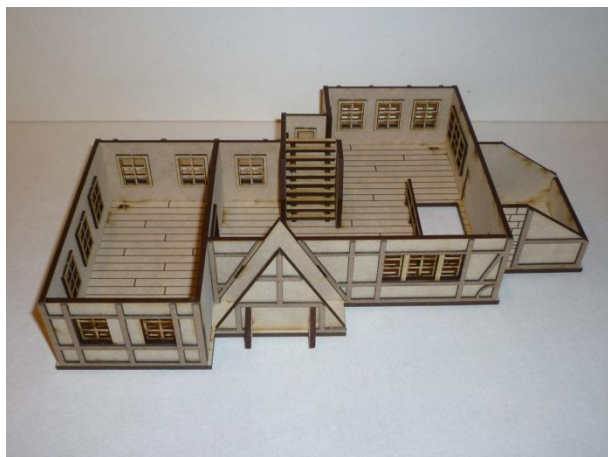

19.

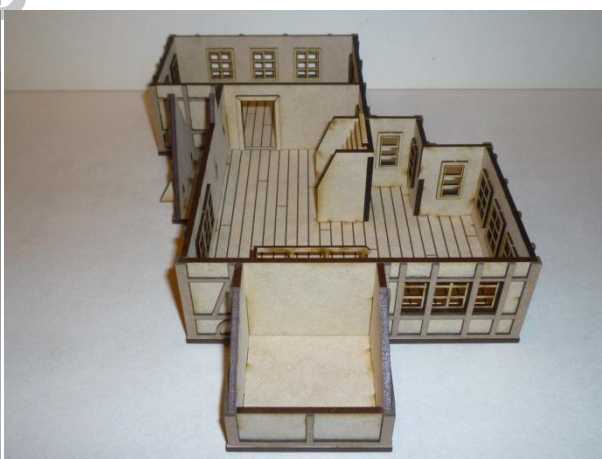
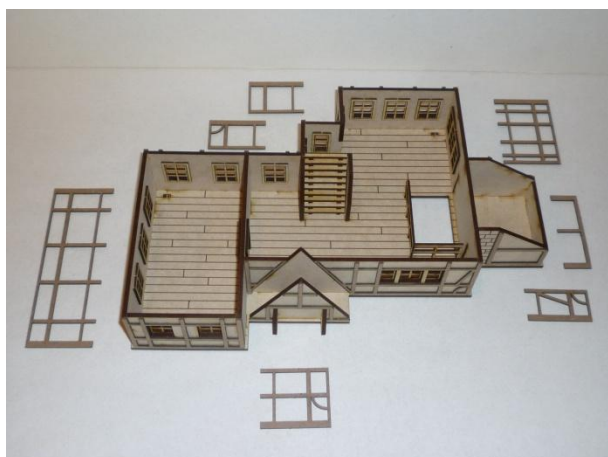



Inspired by Sleepy Hollow – The Movie

20.

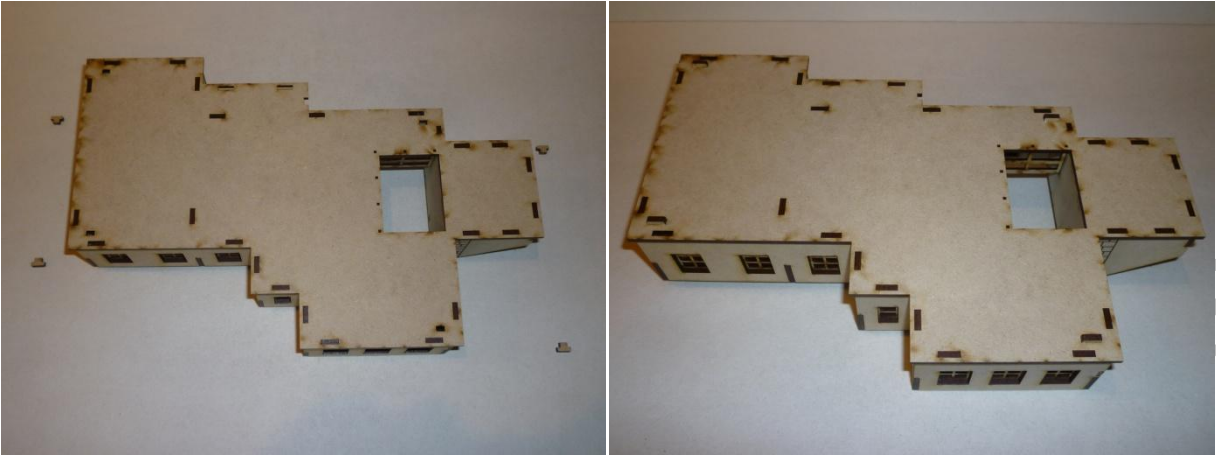

21. 3rd Floor

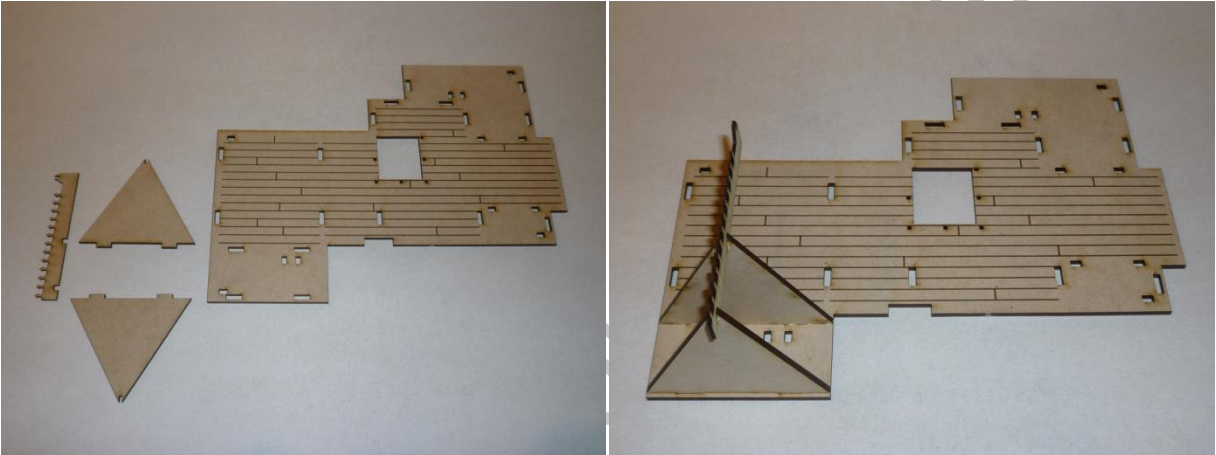

22.

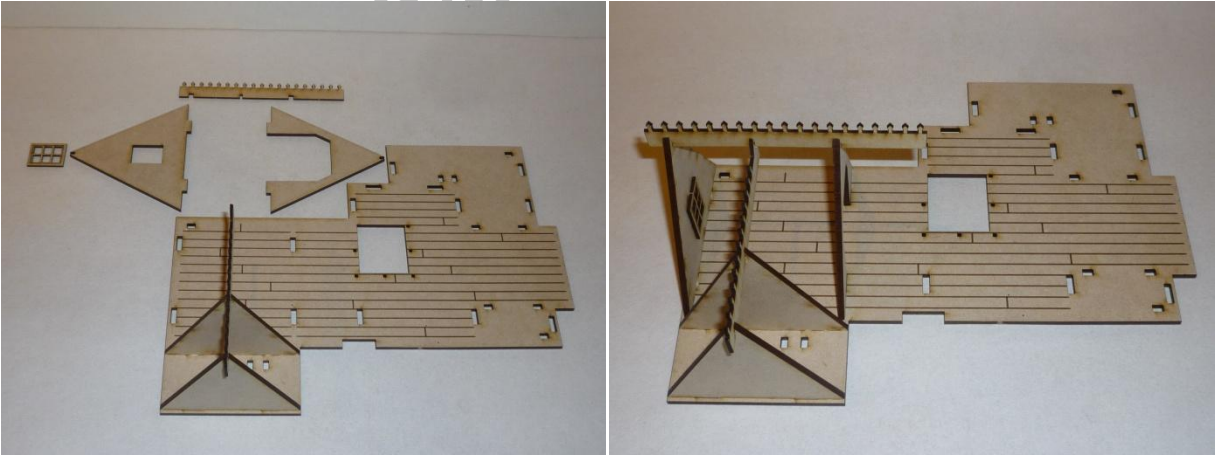

Inspired by Sleepy Hollow – The Movie



Things from the Basement, LLC
Dollhouse & Wargaming Miniatures

23.

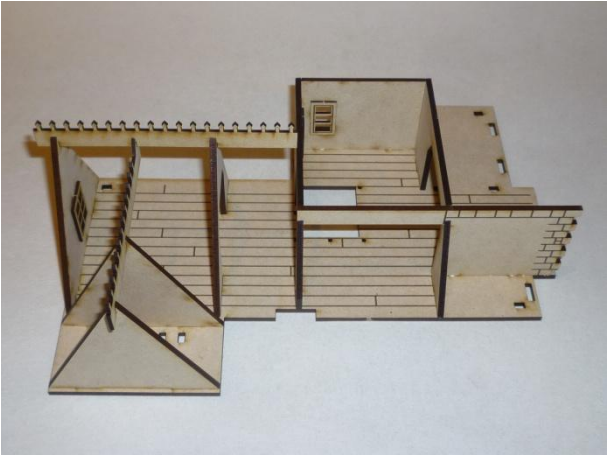
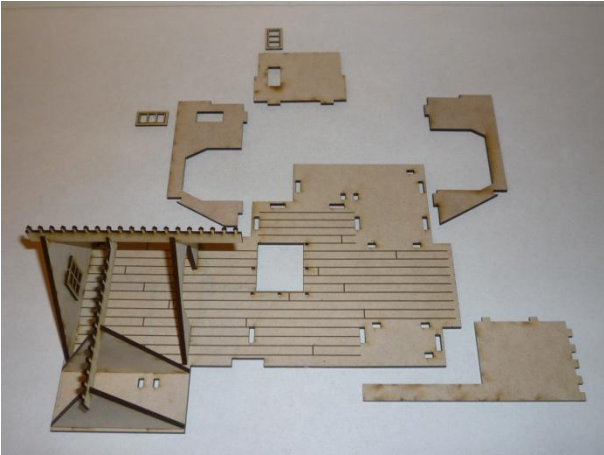

24.

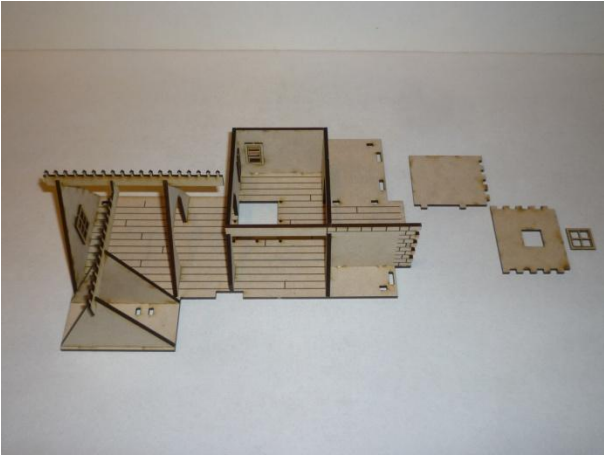

25.

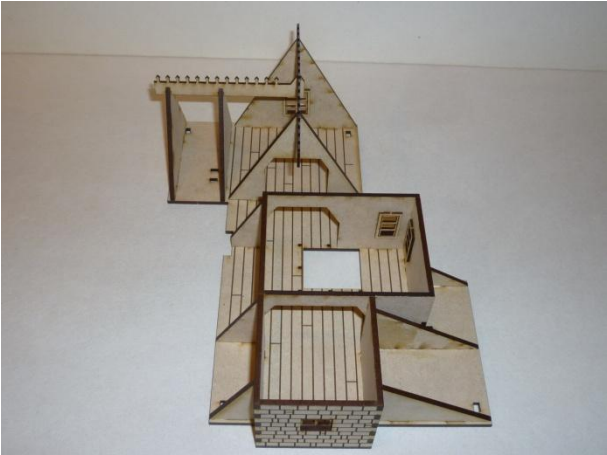
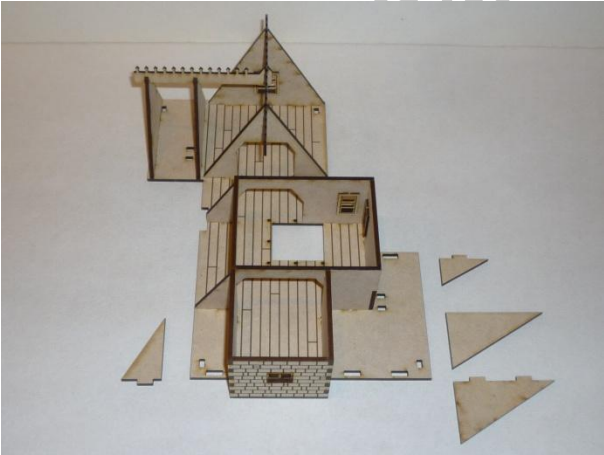



Inspired by Sleepy Hollow – The Movie

26.



27.

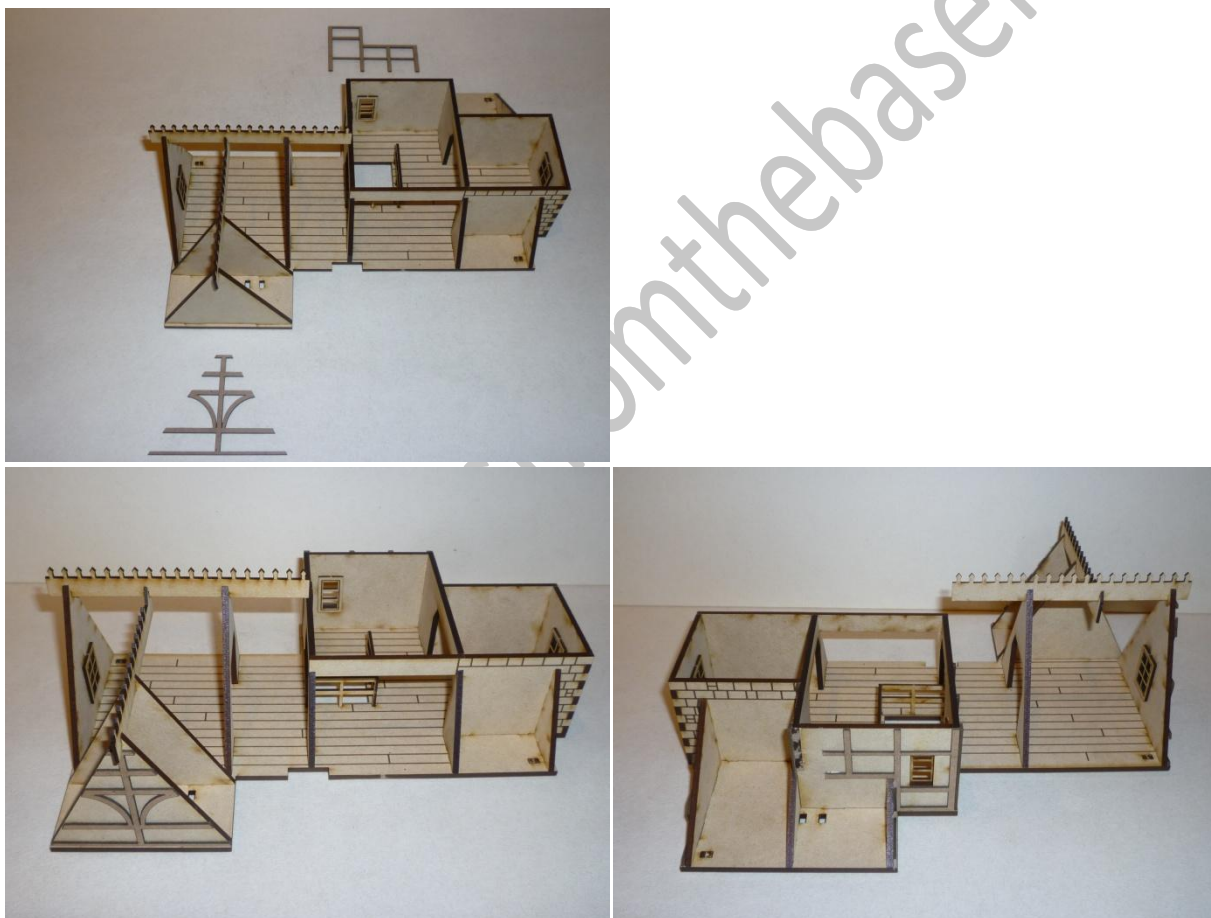

Inspired by Sleepy Hollow – The Movie



Things from the Basement, LLC
Dollhouse & Wargaming Miniatures

28.

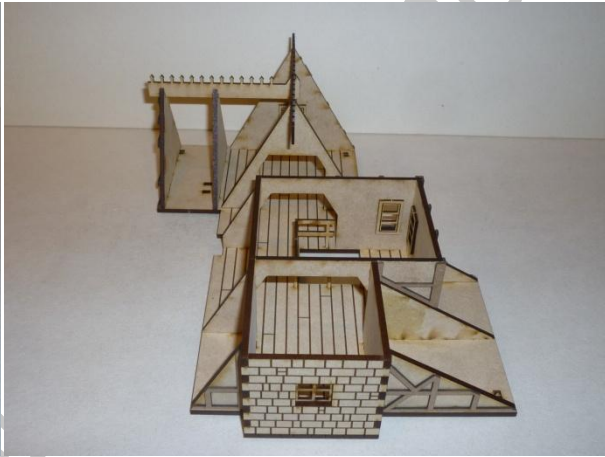
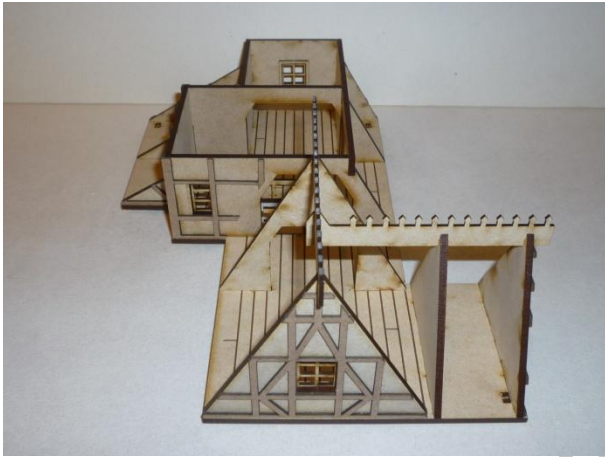
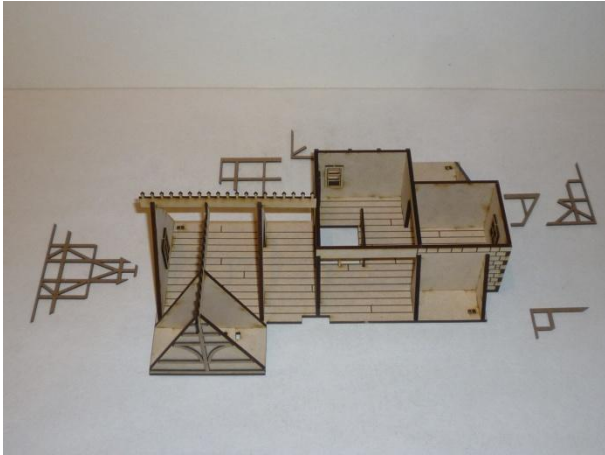

29.

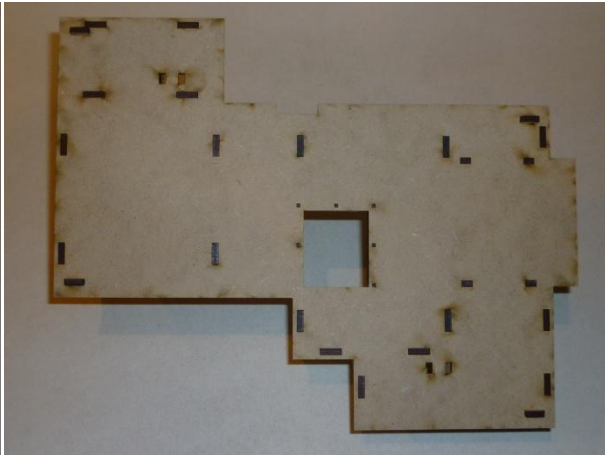
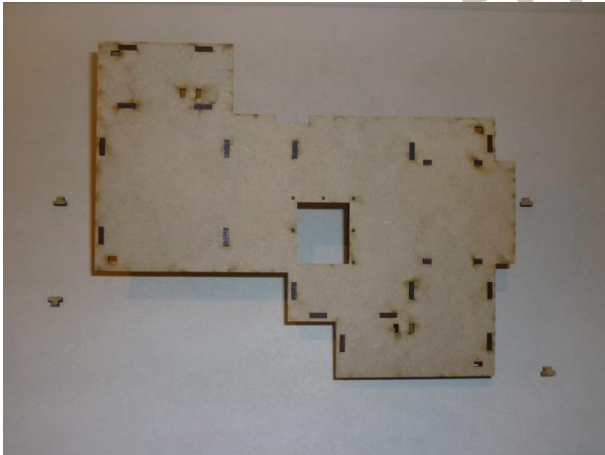



Inspired by Sleepy Hollow – The Movie

30. 4th Floor/Tower

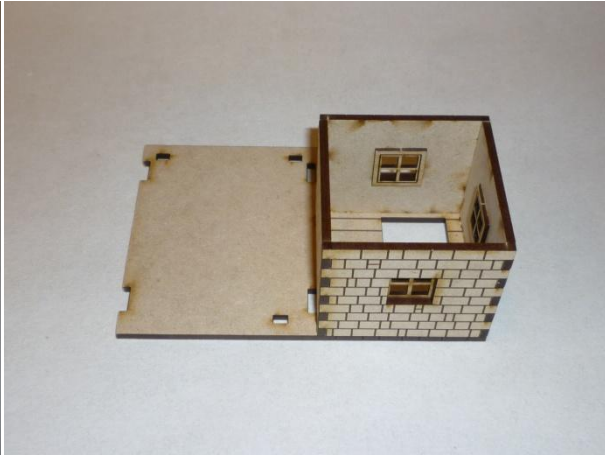
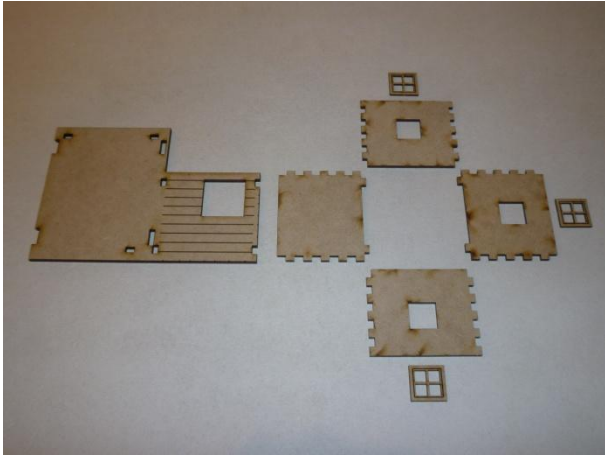

31.

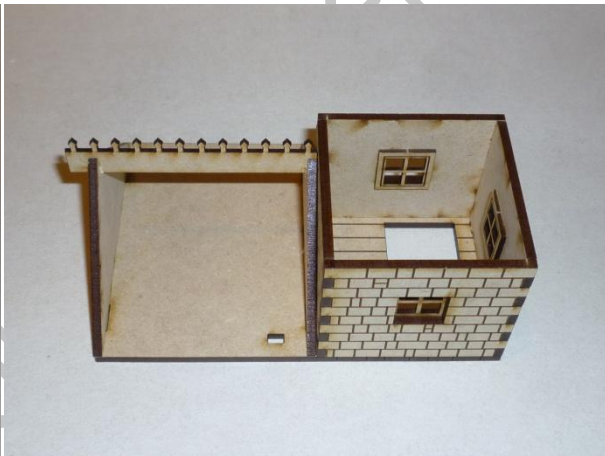
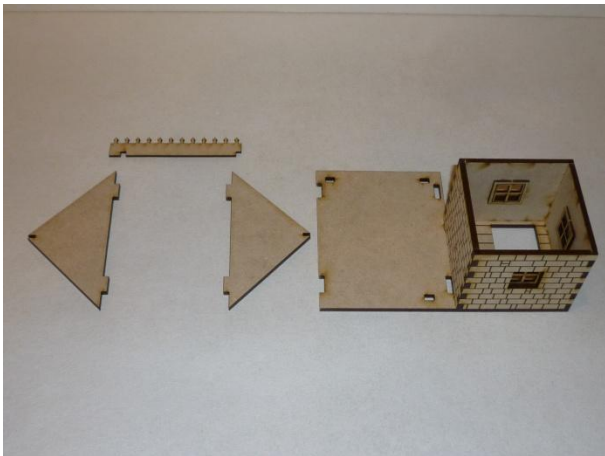

32.

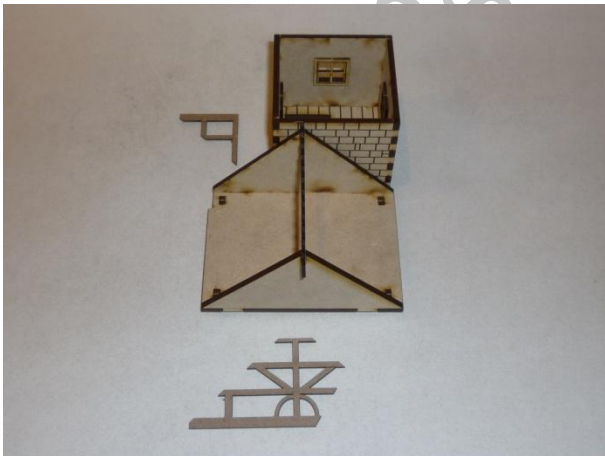

Inspired by Sleepy Hollow – The Movie



Things from the Basement, LLC
Dollhouse & Wargaming Miniatures



33.

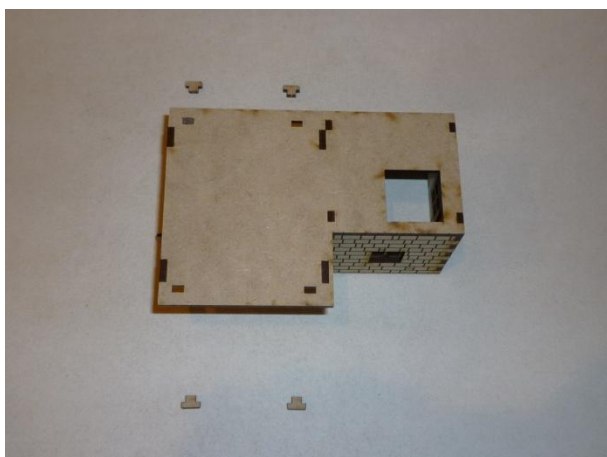

34.

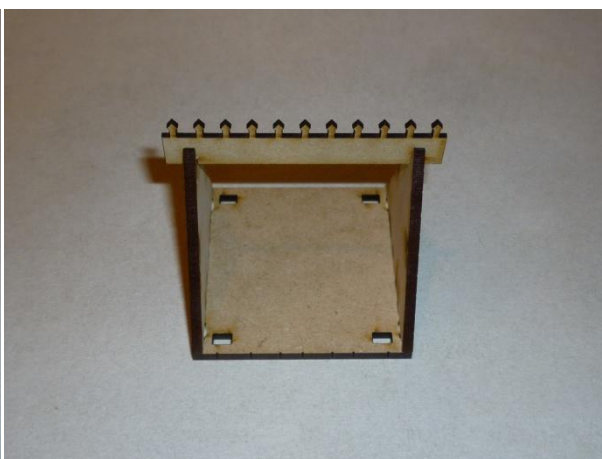
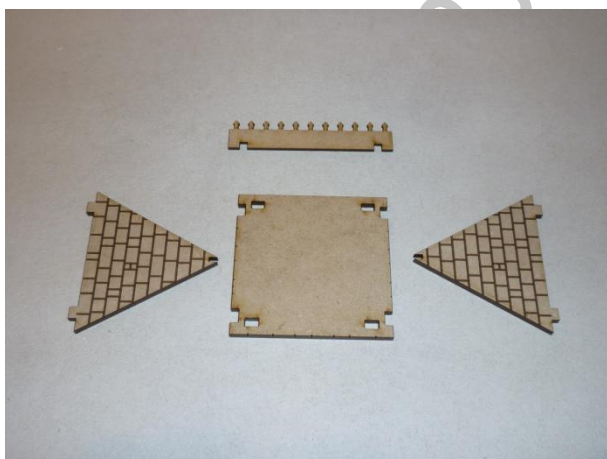



Inspired by Sleepy Hollow – The Movie

35.

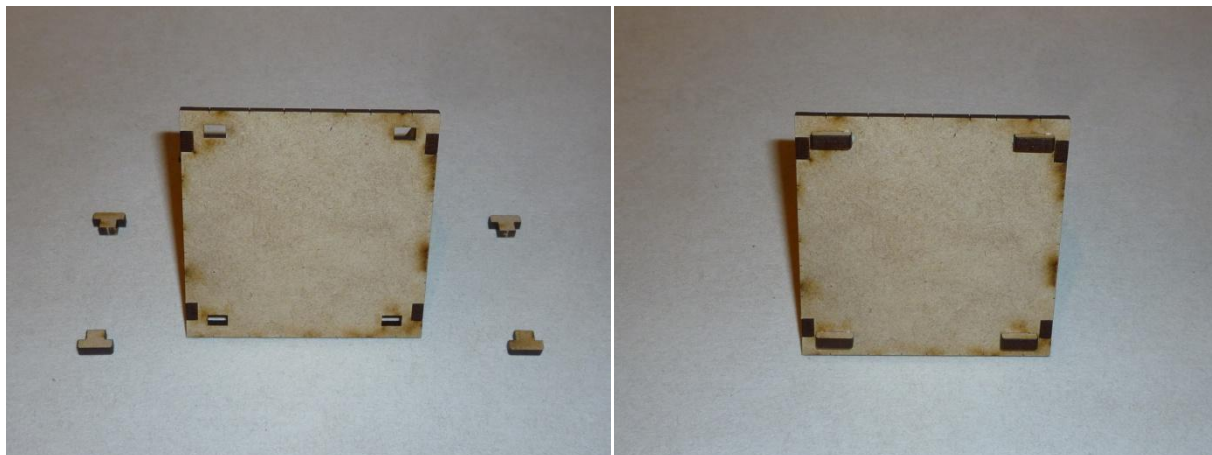

36.

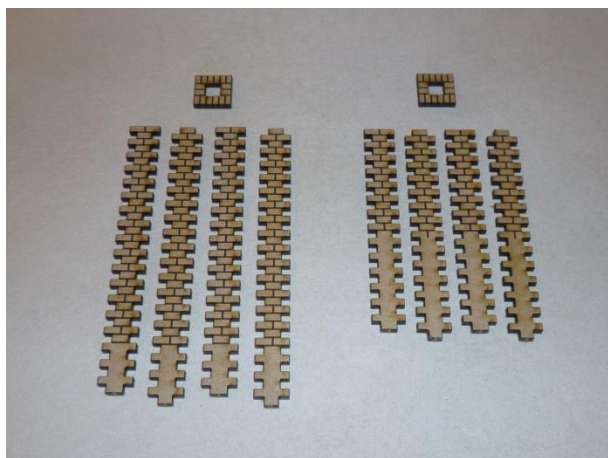

37.

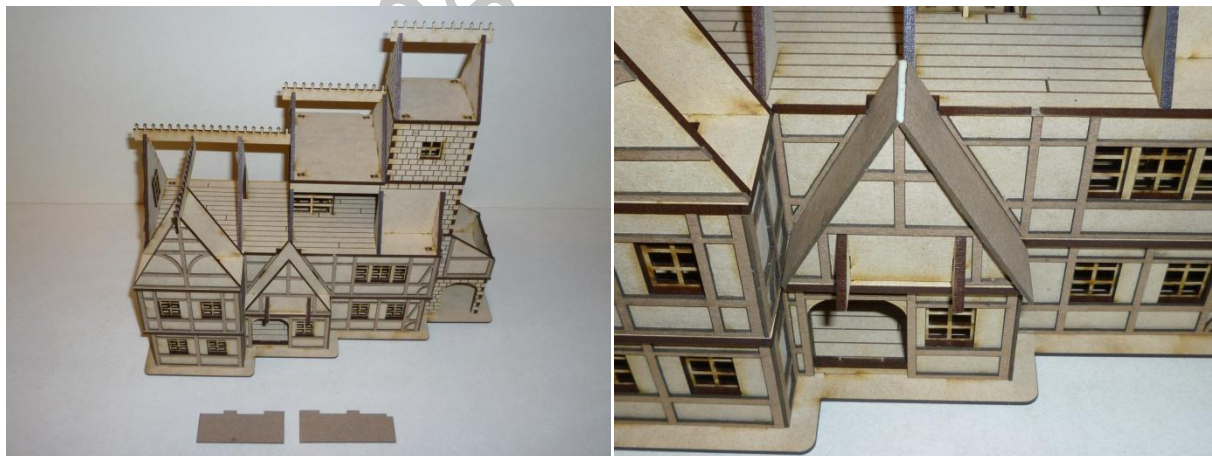



Inspired by Sleepy Hollow – The Movie

38.

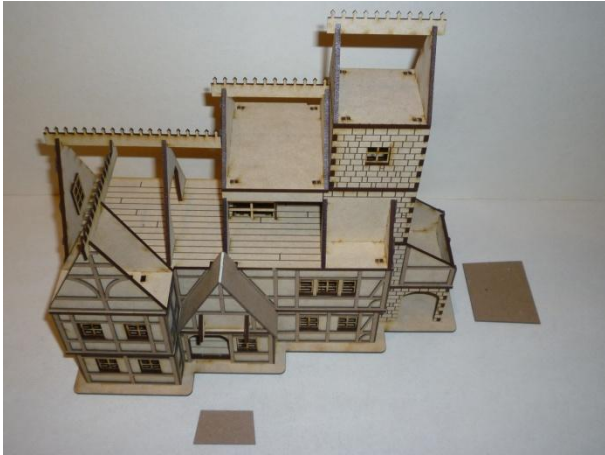

39.

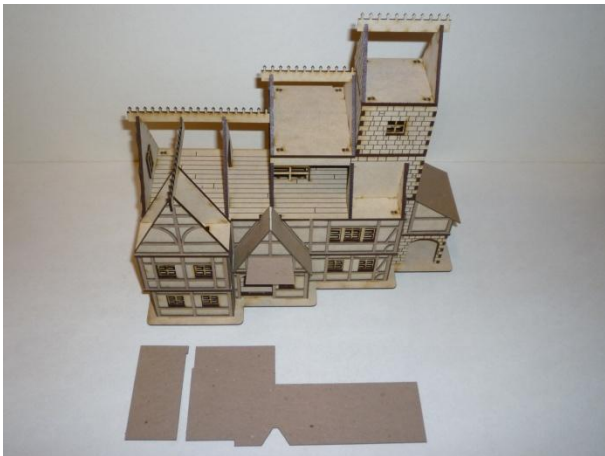

40. Use shorter chimney!

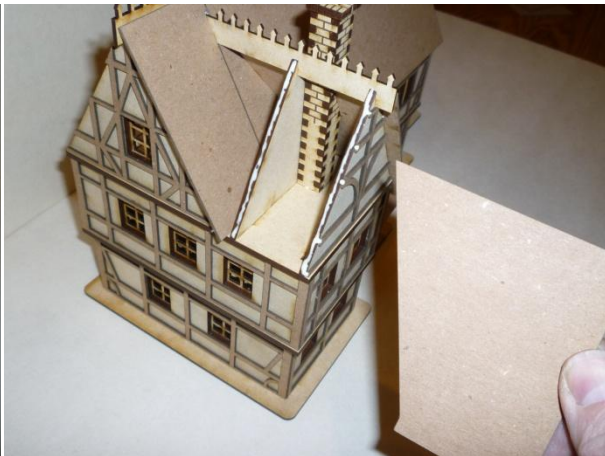
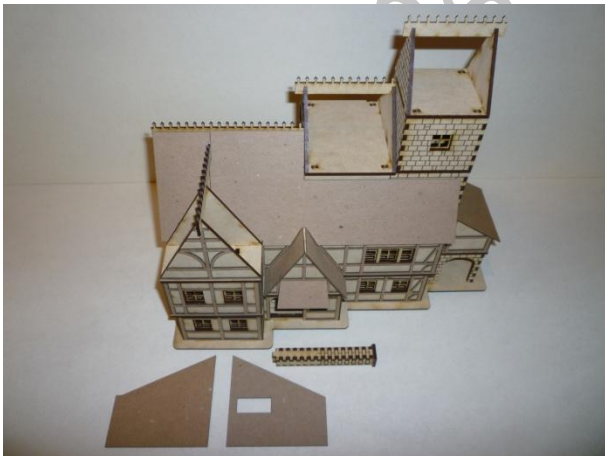

Inspired by Sleepy Hollow – The Movie



Things from the Basement, LLC
Dollhouse & Wargaming Miniatures



41. Use longer chimney!

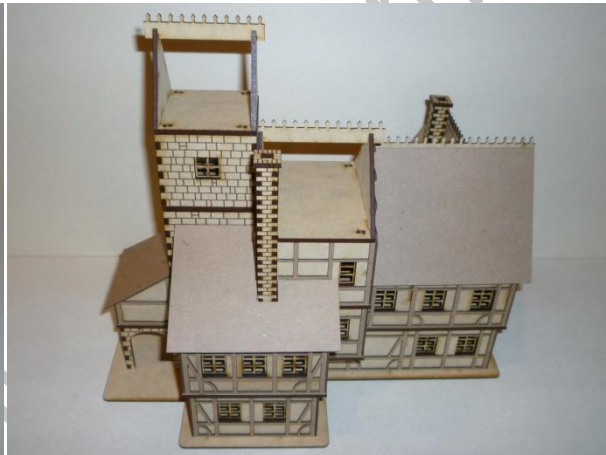
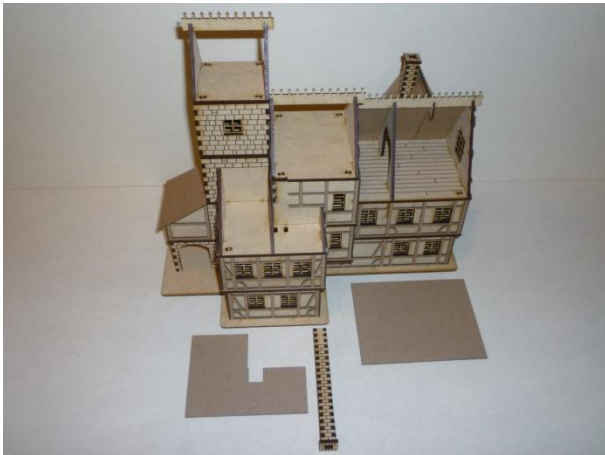

42.

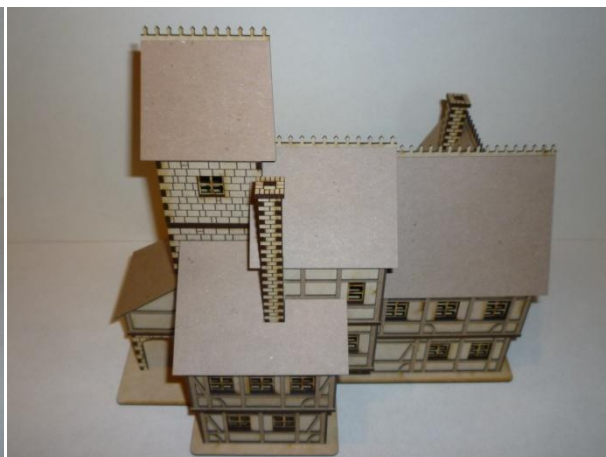
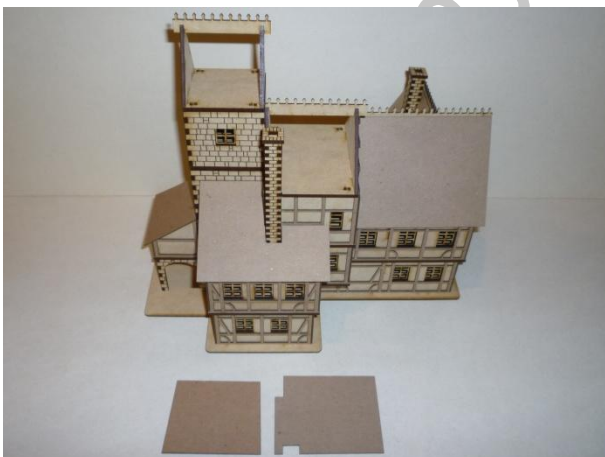

Inspired by Sleepy Hollow – The Movie



Things from the Basement, LLC
Dollhouse & Wargaming Miniatures

43.

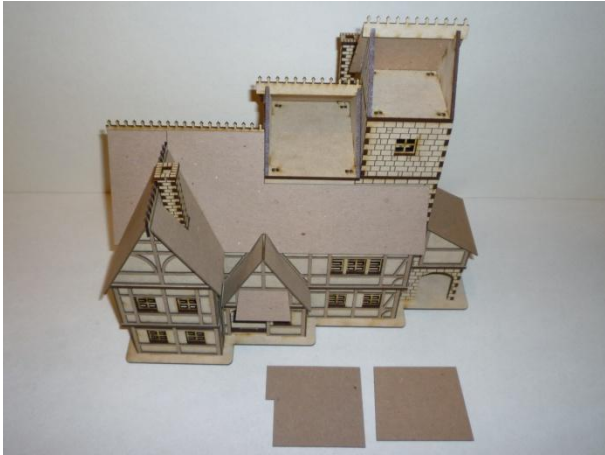

44.

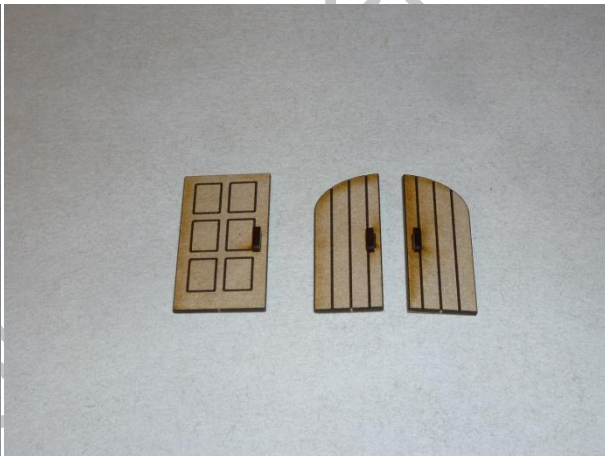
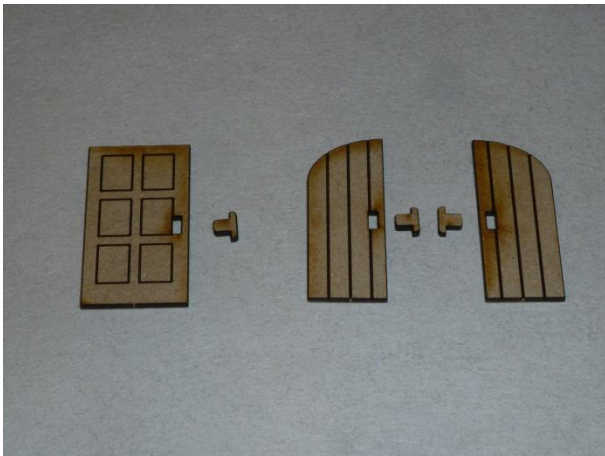

45.



Inspired by Sleepy Hollow – The Movie



Things from the Basement, LLC
Dollhouse & Wargaming Miniatures

For an even more detailed look you may want to add roof tiles. They are easily made from scratch using cardboard or thick paper.

Or you can use different styles of shingle strips which are sold separately at www.thingsfromthebasement.com.

If you ever experience problems or difficulties in finishing this kit don't become desperate! Just send me an email at thingsfromthebasement@gmail.com and I will help you get it done. Having designed the kit and then providing an instruction for everyone to understand is probably the hardest part of the whole project. I am ready for every kind of feedback to improve kit and instructions. I just need to know!

Photos of finished kit:

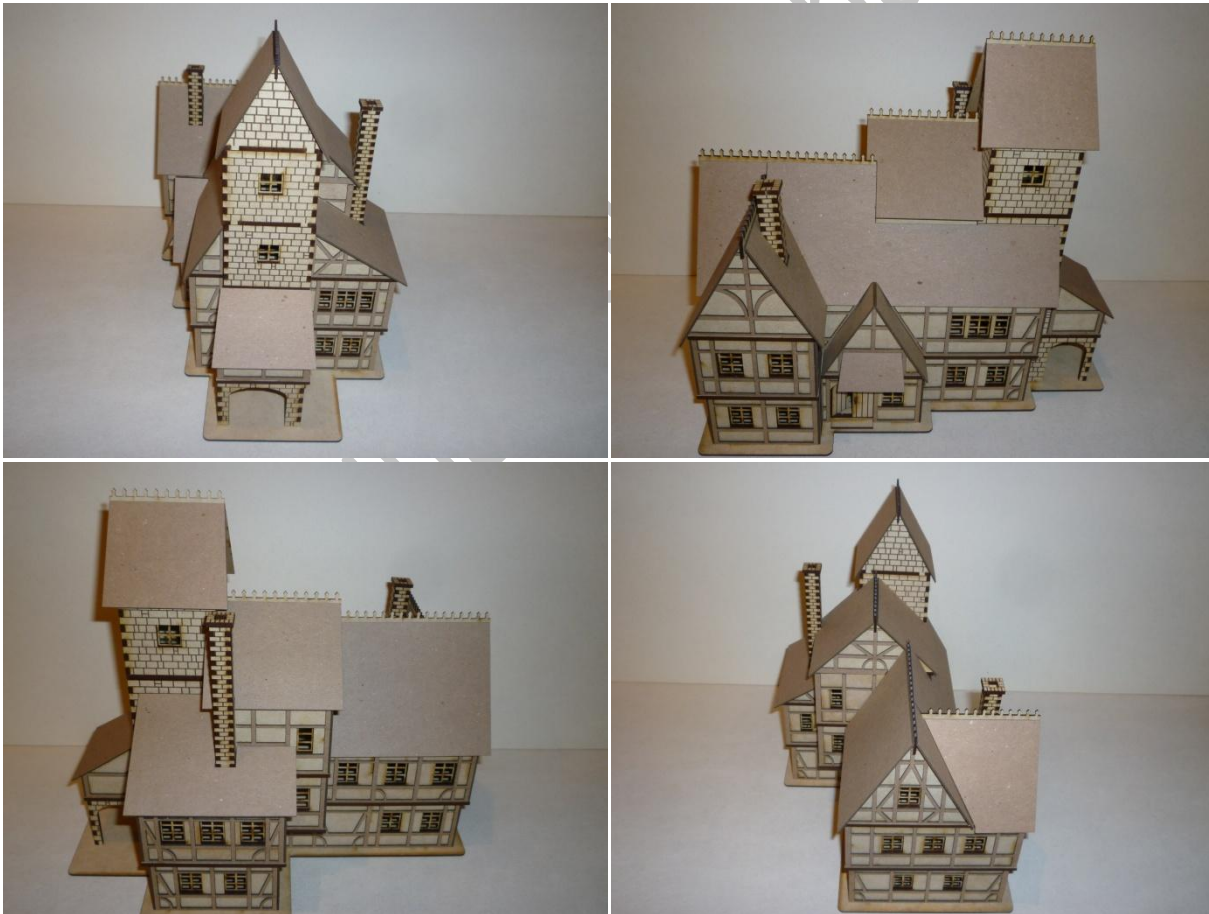

Inspired by Sleepy Hollow – The Movie



Things from the Basement, LLC
Dollhouse & Wargaming Miniatures

